

CLASSIFICATION	PLANT INFORMATION			QTY	SIZE		HEALTH	
	Latin Name	Common Name	Woodland Reserve		Total Qty	Est. Dia	Est. Hgt	Comment
Trees / Palms								
Invasive - Class 1	<i>Casuarina equisetifolia</i>	Australian Whistling Pine	50	50	5 ft	6-7ft OH	Remove	Juvenile
Invasive - Class 2	<i>Casuarina equisetifolia</i>	Australian Whistling Pine	18	18	6 ft	6-7ft	Remove	Mature
Endemic	<i>Cassine laneana</i>	Bermuda Olivewood	3	3	3-5ft	7-10ft	Growing strongly, issue with over growth by morning glory and asparagus wedding fern	Semi-mature
Invasive - Class 2	<i>Citharexylum spinosum</i>	Fiddlewood	7	7	c. 10-15 ft	10-20 ft	Remove	Some wind damage to canopys but mainly protected from exposure by Bay Grapes
Native	<i>Cocoloba uvifera</i>	Sea Grape / Bay Grape	20	20	3-5ft	4-10ft OH	Young growth, healthy - protected from exposure	Healthy, clean canopy
Native	<i>Cocoloba uvifera</i>	Sea Grape / Bay Grape	10	10	10-15ft	15-20ft+ OH	Base clear stemmed due to light levels, growth healthy, some transplantable. Retain larger specimens in place where possible	Healthy, clean canopy - some storm damage to canopys
Native	<i>Conocarpus erectus</i>	Green Buttonwood	5	5	4-12ft	5-10ft	Growing on the northern boundary with South Road, good buffer, strong growth, issue with overgrowth by morning glory and asparagus wedding fern	Juvenile, semi-mature, mature
Invasive - Class 1	<i>Livistonia chinensis</i>	Chinese Fan Palm	-	-	8-10 ft	8-12 ft OH	Remove	Juvenile, healthy, no signs of distress
Invasive - Class 1	<i>Buddleia madagascariensis</i>	Madagascar Buddliea	6	6	5-6ft	4-6ft	Remove	Juvenile, healthy, no signs of distress
Shrubs								
113								
Invasive - Class 1	<i>Asparagus setaceus</i>	Wedding Asparagus Fern	-	-	(100+ Plants)		Remove - covers throughout the area - choking slower growing shrub and tree species	
Native	<i>Borrchia arborescens</i>	Green Sea Ox-eye	40	40	(40+ Plants)		Cliff top planting on ersion line	Healthy
Invasive - Class 1	<i>Cardiospermum halicacabum</i>	Large Fruited Balloon Vine	-	-	(100+ Plants)		Remove	Present throughout the area - choking and smoothing larger plants
Invasive - Class 2	<i>Eugenia uniflora</i>	Suriname Cherry	5	5	4-6ft	6-12ft	Remove	Semi-mature
Invasive - Class 1	<i>Ipomoea indica</i>	Morning Glory	-	-	(100+ Plants)		Remove	Present throughout the area - choking and smothering larger plants
Ornamental	<i>Lantana camara</i>	Shrub Verbena	3	3			Young to Middle aged growth profile - mishapen from growth competition	Mature
Ornamental	<i>Pittosporum tobria</i>	Pittosporum	3	3	4-12ft	5-10ft	Internal hedging	Aged, some died back
Invasive - Class 1	<i>Ricinus communis</i>	Castor Oil Plant	-	-	(10+ Plants)		Remove	Present in areas of distrubed ground
Invasive - Class 1	<i>Schinus terebinthifolius</i>	Mexican/Brazilian Pepper	-	-	(30+ Plants)		Remove	Juvenile regrowth
Native	<i>Solidago sempervirens</i>	Seaside Golden Rod	40	40	(40+ Plants)		Various stages of growth cycle, good coverage - getting over grown by asparagus wedding fern	Weak growth

Invasive - Class 2	<i>Wedelia trilobata</i>	Wedelia	-	-	(50+ Plants)		Sporadic ground cover, competing with the asparagus wedding fern for space where it occurs - Remove	Healthy
Grasses								
Invasive - Class 2	<i>Eleusine indica</i>	Goose Grass	-	-			Remove	Competing with ground cover in areas and present in areas of disturbed ground
Ornamental	<i>Stenotaphrum secundatum</i>	St. Augustine 'Floritam'	-	-			Sporadic coverage - competing with asparagus wedding fern - protected from exposure	Weak growth

BERMUDIANA BEACH RESORT EVENT LAWN CONSERVATION MANAGEMENT PLAN

1.0 OUTLINE SUMMARY

THE PRIMARY AIM OF THIS DOCUMENT IS TO LAYOUT A PLAN AND ESTABLISH A METHODOLOGY FOR PLANTING AND LANDSCAPE WORKS IN ORDER TO RETAIN THE CONSERVATION VALUE OF THE PORTION OF WOODLAND RESERVE ZONED AREA AT THE EASTERN END LOT 44693 WHICH MAKES UP PART OF SOUTHLANDS PARK

THIS PLANTING CONSERVATION MANAGEMENT PLAN (CMP) IDENTIFIES THE AREA OF THE PROPOSED EVENT LAWN LAWN FOR THE BERMUDIANA BEACH RESORT.

IN ORDER TO HELP ACHIEVE DEFINED OBJECTIVES, THE FOLLOWING AREAS HAVE BEEN IDENTIFIED:

AREA A: PARK
AREA B: WOODLAND RESERVE

1.0 INTRODUCTION

THIS DOCUMENT ESTABLISHES AN ENVIRONMENTALLY BASED METHODOLOGY FOR CONSERVATION MANAGEMENT. IT PROVIDES A STRATEGY FOR PLANTING AND LANDSCAPE WORKS THAT ARE WELL THOUGHT OUT AND IN KEEPING WITH THE PROPOSED USE AND WOODLAND RESERVE POLICIES AND OBJECTIVES. THE METHODOLOGY INCLUDES THE REMOVAL OF INVASIVE SPECIES, MAKING ROOM FOR NEW PLANTINGS OF PRIMARILY ENDEMIC AND NATIVE SPECIES. THE CONSERVATION MANAGEMENT APPROACH AIMS TO ACHIEVE AND SUSTAIN AN ATTRACTIVE, VALUABLE AMENITY FOR THE PROPERTY AND MANAGEMENT OF THE BORDERING WOODLAND RESERVE AND THE COASTAL LANDSCAPE ENVIRONMENT.

2.0 LOCATION

THE PROJECT AREA IS SITUATED IN THE SOUTH EASTERN CORNER OF LOT 44693 WHICH IS PART OF SOUTHLANDS PARK ON SOUTH ROAD IN WARWICK. ZONING IS DESIGNATED AS PARK WITH AN OVERLAY OF WOODLAND RESERVE BORDERING SOUTH ROAD ACCORDING TO THE BERMUDA PLAN, 2018, PLANNING STANDARD.

THE PROPOSED EVENT SPACE COVERS APPROXIMATELY 10,750 SQUARE FEET. ITS PRIMARY CHARACTER IS THAT OF UNMANAGED WOODLAND WITH NOTED POCKETS OF RECENT NATIVE AND ENDEMIC PLANTING AND FLANKED ON THE COASTAL BOUNDARY BY A COMBINATION OF NATIVE & ENDEMIC COASTAL SPECIES, AND INVASIVE SPECIES.

3.0 EVALUATION AND OBJECTIVES

3.1 OBJECTIVES OF THE CONSERVATION MANAGEMENT PLAN TO CREATE A HOMOGENEOUS PLANTING SCHEME THAT WILL PRESERVE THE INTEGRITY OF AND ENHANCE THE SURROUNDING WOODLAND RESERVE WHILE INTEGRATING A FUNCTIONAL EVENT SPACE FOR USE BY THE ADJOINING BERMUDIANA BEACH RESORT. THE FOLLOWING OBJECTIVES ILLUSTRATE HOW IT IS POSSIBLE TO INTEGRATE ENVIRONMENTAL QUALITIES WITH MODERN LANDSCAPE MANAGEMENT PRACTICES TO ENHANCE THE BERMUDA IMAGE AND THE TOURISM PRODUCT IN ACCORDANCE WITH CURRENT LANDSCAPE STRATEGIES EMPLOYED BY DENR.

3.2 MANAGEMENT OBJECTIVES

- PROTECT, PRESERVE AND ENHANCE WOODLAND RESERVE QUALITIES
- REDUCE INVASIVE SPECIES IN THE BOUNDARY AREAS OF THE EVENT SPACE
- ENHANCE EXISTING NATIVE AND ENDEMIC VEGETATION FOR ADDED AMENITY VALUE AND TO INCREASE AREAS FOR BIRDS AND WILDLIFE

3.3 IDENTIFICATION / CONFIRMATION OF IMPORTANT FEATURES

- ESTABLISHING CURRENT SITE VEGETATION TO BE RELOCATED ON SITE AND IDENTIFYING KEY SPECIES OF VALUE

3.4 FACTORS INFLUENCING MANAGEMENT

- INVASIVE TREE ESTABLISHMENT/ENCROACHMENT
- CLIFF EROSION / DEGRADATION
- INSECT / DISEASE / DAMAGE TO YOUNG TREES / TRESPASSING / VANDALISM / LITTER

3.5 DEPARTMENT OF PLANNING POLICY

THE DEVELOPMENT AND PLANNING ACT 1974 MAKES SPECIFIC PROVISION FOR THE DESIGNATION OF 'AREAS OF SPECIAL ENVIRONMENTAL VALUE' IN THE FOURTH SCHEDULE (SECTION 28).

THESE 'DESIGNATED AREA PROTECTIONS' ARE ENCOMPASSED IN THE BERMUDA PLAN 2018.

4.0 CONSERVATION MANAGEMENT PROCEDURE

4.1 MANAGEMENT PROCESS / REPORT STRUCTURE

THE FOLLOWING SECTIONS OF THE MANAGEMENT PLAN OUTLINE THE PRACTICAL APPLICATION AND TIMING OF THE MANAGEMENT OBJECTIVES, WHICH ACT AS A GUIDE IN CONSULTATION WITH THE LANDSCAPE ARCHITECT TO ASSESS THE ACTIONS REQUIRED.

THE DOP AND / OR DENR SHALL CARRY OUT A SITE INSPECTION FOR COMPLIANCE WITH THIS CONSERVATION MANAGEMENT PLAN UNLESS OTHERWISE AGREED IN WRITING.

THE MANAGEMENT PROCEDURE IS DIVIDED INTO FOUR PARTS AS FOLLOWS:

- INITIAL INSTALLATION-SPECIFIC METHODS
- INITIAL INSTALLATION-GENERAL METHODS (TOTAL MANAGEMENT AREA)
- MAINTENANCE PROGRAMME, TO ENSURE THE ESTABLISHMENT OF ALL INSTALL PLANTINGS DURING CRITICAL EARLY STAGES
- LONG-TERM MANAGEMENT OBLIGATIONS FOR REMEDIATION AND IMPROVEMENT OF THE LANDSCAPE WHICH INVOLVES 6-MONTH CULLING OF INVASIVE PLANT SEEDLINGS.

5.0 GROUND PREPARATION

- A LIMIT OF WORKS LINE SHALL BE ESTABLISHED FOR WORK AREAS IN ADVANCE OF ANY WORKS
- PROTECTIVE FENCING TO BE ERRECTED AROUND AT-RISK TREES TO BE RETAINED IN PLACE
 - NO EXISTING GROWING MEDIUM IS TO BE REMOVED OFF SITE
 - EXCAVATORS SHALL BE PERMITTED FOR TREE PIT EXCAVATION PURPOSES IN AREAS DEEMED SUITABLE
 - TREE PITS SHOULD BE EXCAVATED FOR NEW TREE PLANTINGS WERE RECOMMENDED (I.E. NOT FOR EASY PLANT). DUE TO A THIN COVERING OF SOIL ON SITE PITS SHOULD BE A MINIMUM OF 4'X4'X4'
 - SPREAD A SOIL LAYER OF 6" MINIMUM OVER NEWLY ESTABLISHED MANAGEMENT AREAS UNLESS OTHERWISE NOTED.

6.0 INITIAL INSTALLATION

6.1 PLANTING WORKS

6.1.1 PLANTING

- PLANTING IS TO BE LAID OUT ON SITE AND CONFIRMED BY THE LANDSCAPE ARCHITECT IN ADVANCE OF ANY FINAL PLANTING.
- WHERE INSTALLING 10GAL PLANTING OR LARGER RANDOM PLANTING WITH VARIED SPACING IS RECOMMENDED (I.E. AVOID REGULARIZED, GRID-LIKE PLANTING FORMATIONS)
- WHEN PLANTING 3 GALLON OR 1 GALLON PLANTS FOR MAXIMUM GROUND COVERAGE GRID LIKE PLANTING FORMATIONS ARE ACCEPTABLE
- PLANTING IS TO BE CARRIED OUT AS SOON AS POSSIBLE AFTER GROUND PREPARATION
- SPREAD MAXIMUM 3" DEEP MARSH FOLLY MULCH LAYER AROUND NEW PLANTING AND OVER MANAGEMENT AREAS. MULCH IS NOT DIRECTLY APPLIED FROM MARSH FOLLY FACILITY DUE TO RESIDUAL HEAT DAMAGE. WHERE POSSIBLE MULCH SHOULD BE STORED AND COVERED WITH A LIGHT IMPENETRABLE COVERING TO KILL ANY WEED SEEDS BY HEATING FOR A PERIOD OF 2 MONTHS PRIOR TO APPLICATION
- PLANT SUBSTITUTIONS WILL NOT BE ACCEPTED UNLESS WRITTEN AUTHORIZATION RECEIVED FROM THE LANDSCAPE ARCHITECT AND WILL THEN BE CONSIDERED AN AMENDMENT TO THE PLANTING SCHEDULE
- THE TERRESTRIAL OFFICER ASSIGNED BY DENR WILL HAVE FINAL DECISION ON ANY AND ALL SUBSTITUTIONS

6.2.2 SPECIFICATION

- ALL PLANT MATERIAL SHALL BE FREE FROM INSECTS AND DISEASE
- PROVIDE HEALTHY, DISEASE-FREE PLANTS OF SPECIES AND VARIETY OUTLINED IN THE PLANTING SCHEDULE. WITH WELL-ESTABLISHED ROOT SYSTEMS REACHING TO SIDES OF THE CONTAINER TO MAINTAIN A FIRM BALL, BUT NOT WITH EXCESSIVE ROOT GROWTH ENCIRCLING THE CONTAINER.
- ALL PLANTING SHALL BE DONE IN ACCORDANCE WITH ACCEPTABLE HORTICULTURAL PRACTICES. THIS INCLUDES PROPER PLANTING MIX, PLANTING BED AND TREE PIT PREPARATION, PRUNING, STAKING OR GUYING, SPRAYING, FERTILIZATION, PLANTING, AND ADEQUATE MAINTENANCE UNTIL ACCEPTANCE BY THE LANDSCAPE ARCHITECT AND DENR.
- GOOD SOIL MIX TO CONSIST OF 1 PART PEAT MOSS TO 4 PARTS TOPSOIL (OR APPROVED OTHER). TOPSOIL TO BE SCREENED TO 3" MINUS, ENSURING IT IS CLEAN OF DEBRIS AND VEGETATION.
- TREE PLANTING PITS SHALL BE 4'X4'X4' DEEP WHERE PRACTICAL. PLANTING PITS TO CONSIST OF GOOD SOIL MIX DEPTH.
- IF TREE PITS ARE TO EXCAVATED FROM ROCK, ENSURE THE BASE IS SLOPED AND FILLED WITH 6" OF FREE DRAINING MATERIAL TO REDUCE ROOT ROT FROM ANY POSSIBLE WATER LOGGING
- SHRUB PLANTINGS TO HAVE MINIMUM 18" GOOD SOIL MIX DEPTH WHERE PRACTICAL. PLANTING PITS FOR SPECIMEN SHRUBS SHALL BE A MINIMUM OF TWICE THE DIA. OF THE POT AND 1.5 TIMES AS DEEP.
- LAWN AREAS TO BE MIN. 6" GOOD SOIL MIX AND PLUGGED WITH ZOYSIA @ 12" ON CENTER AND TO BE OVER SEEDED WITH RYE GRASS SEED (WINTER) OR BERMUDA GRASS SEED (SUMMER) AT RATE OF 1.5LB PER 500 FT2. (ZOYSIA TO BE USED BASED ON COASTAL EXPOSURE AND PROPOSED AREA USAGE)
- ALL GRASS, VEGETATION, ROCKS, AND OTHERS DEBRIS SHALL BE REMOVED FROM PLANTING AREAS.
- FINAL GRADING SHALL BE APPROVED BY THE LANDSCAPE ARCHITECT IN THE FIELD PRIOR TO PLANTING.

- TREE STABILIZATION METHODS TO INCLUDE STAKING OR GUYING OR BELOW GRADE STAKING SYSTEMS FOR HIGHLY VISIBLE TREES AND PALMS AND OTHER TREES AS DETERMINED.
- LOCATION OF PLANT MATERIALS SHALL BE APPROVED BY THE LANDSCAPE ARCHITECT IN THE FIELD PRIOR TO INSTALLATION. THE LANDSCAPE ARCHITECT RESERVES THE RIGHT TO ADJUST PLANTS TO EXACT LOCATION IN THE FIELD.
- ALL PRUNING, SHAPING AND TRIMMING OF EXISTING VEGETATION TO BE REVIEWED WITH LANDSCAPE ARCHITECT ON SITE PRIOR TO OPERATIONS.
- ALL PLANTING AREAS SHALL BE MULCHED WITH 3" OF CLEAN MULCH AFTER INSTALLATION. MULCH IS NOT DIRECTLY APPLIED FROM MARSH FOLLY FACILITY DUE TO RESIDUAL HEAT DAMAGE.
- CONTRACTOR TO PRESERVE ALL EXISTING VEGETATION UNLESS OTHERWISE NOTED.
- MAINTENANCE IS TO BEGIN IMMEDIATELY AFTER PLANTS ARE INSTALLED AND CONTINUE UNTIL PLANTINGS ARE ACCEPTED AT THE POINT OF MAJORITY COMPLETION. MAINTENANCE SHALL CONTINUE FOR A 12-MONTH PERIOD FROM SIGN-OFF ON SUBSTANTIAL COMPLETION.
- WIND SCREENING AND WIND BARRIERS SHOULD BE ASSESSED AFTER PLANTING, THREE (3) MONTHS AFTER PLANTING AND SIX (6) MONTHS AFTER PLANTING.
- ROUTINE WATERING SHOULD BE UNDERTAKEN TO PREVENT DRYING OUT AND PROMOTE ESTABLISHMENT OF PLANTING. A MINIMUM OF 3 WATERINGS PER WEEK FOR THE FIRST MONTH AND DURING DRY PERIODS FOR THE REMAINDER OF THE MAINTENANCE PERIOD. WATERING SHALL BE UNDERTAKEN TO THE FULL DEPTH OF THE TOPSOIL. WATER TO BE PROVIDED BY THE OWNER.
- PLANT MATERIAL SHALL BE REPLACED IF MATERIAL DIES DUE TO CONTRACTOR NEGLIGENCE WITHIN A SIX (6) MONTH PERIOD FOR ALL SHRUBS, AND A TWELVE (12) MONTH PERIOD FOR ALL TREE AND PALMS
- WEEDS AND INVASIVE SPECIES SHOULD BE ROUTINELY REMOVED DURING THE MAINTENANCE PERIOD. THE FULL PLANT INCLUDING THE ROOT SYSTEM SHOULD BE REMOVED TO PREVENT REGROWTH
- DISEASED OR INFESTED STOCK SHOULD BE TREATED WITH AVAILABLE HERBICIDES / PESTICIDES OR ORGANIC METHODS DEPENDING ON AREA SENSITIVITY.
- LITTER SHOULD ROUTINELY BE CLEARED FROM ALL PLANTING AREAS
- ACTS OF VANDALISM SHOULD BE REPORTED AND REPAIRED, IN PARTICULAR ACTS RELATING TO STOLEN OR DAMAGED PLANT STOCK.
- ADDITIONAL TOPSOIL SHALL BE ADDED TO PLANTING AREAS SHOULD EXCESSIVE SETTLING OCCUR WITHIN THE MAINTENANCE PERIOD. TOPSOIL TO BE OF THE ORIGINAL SPECIFIED MIX.
- THE LAWN AREA IS TO BE TOP DRESSED DURING THE INITIAL MAINTENANCE PERIOD TO ENSURE ALL UNEVEN AREAS ARE LEVELLED TO CREATE A SMOOTH SURFACE.

6.2.3 NOTES

- IT IS RECOMMENDED THAT THE LANDSCAPE ARCHITECT LIAISE WITH THE CHOSEN CONTRACTOR OR OTHER PERSONS CARRYING OUT THE WORK PRIOR TO START OF WORKS AND TO UNDERTAKE INTERIM SITE REVIEWS IF NECESSARY
- DISPOSAL OF TOXIC MATERIALS IS NOT PERMITTED ON SITE. ALL TOXIC MATERIALS SHOULD BE TAKEN OFF-SITE AND DISPOSED OF PROPERLY.
- ARRANGING PRE-GROWN NURSERY STOCK MAY BE NECESSARY FOR SOME PLANT VARIETIES
- SCALE RESISTANT VARIETIES OF BERMUDA CEDAR SHOULD BE USED
- ADDITIONAL PLANTING AND UPGRADES ARE RECOMMENDED BEYOND THE TIME FRAME OF THIS MANAGEMENT PLAN

7.0 MAINTENANCE PROGRAMME

7.1 GENERAL NOTES

A MAINTENANCE PROGRAMME IS ESSENTIAL FOR THE ESTABLISHMENT AND LONG-TERM SURVIVAL OF NEW PLANT MATERIAL. MAINTENANCE IS TO BEGIN IMMEDIATELY AFTER PLANTS ARE INSTALLED AND CONTINUE UNTIL PLANTINGS ARE ACCEPTED AT THE POINT OF MAJORITY COMPLETION. THE INSTALLATION CONTRACTOR SHALL PROVIDE MAINTENANCE FOR A MINIMUM 12-MONTH PERIOD FROM THE POINT OF MAJORITY COMPLETION. MAINTENANCE IS ULTIMATELY THE FIRST STEP TO HELP ENSURE THAT LONG TERM OBJECTIVES WILL BE MET.

ROUTINE WATERING AND FERTILIZING
ROUTINE WATERING SHOULD BE UNDERTAKEN TO PREVENT DRYING OUT AND PROMOTE ESTABLISHMENT OF PLANTINGS. A MINIMUM OF 3 WATERINGS PER WEEK IS RECOMMENDED FOR THE FIRST MONTH AND DURING DRY PERIODS FOR THE REMAINDER OF THE MAINTENANCE PROGRAMME. WATERING SHALL BE UNDERTAKEN TO THE FULL DEPTH OF THE TOPSOIL. WATER TO BE PROVIDED BY THE OWNER. ALLOWANCE SHOULD TO BE MADE FOR DISTRIBUTION AROUND SITE. 2 ROUNDS OF FERTILIZING WILL BE NECESSARY TO AID PLANT ESTABLISHED

7.3 REPLACING DEAD PLANT MATERIAL
IF PLANT MATERIAL PERISHES, IT BE REPLACED IN A TIMELY FASHION TO ENSURE THE BOUNDARY AREAS MAINTAIN THEIR WOODLAND APPEARANCE ALL REPLACEMENT PLANTS TO BE INSPECTED BY THE LANDSCAPE ARCHITECT PRIOR TO REPLANTING TO ENSURE A SUITABLE SPECIES AND SIZE HAS BEEN SELECTED

7.4 MULCHING
ADDITIONAL MULCH SHALL BE ADDED TO PLANTING AREAS BI ANNUALLY TO ENRICH SOIL NUTRIENT CONTENT AND TO ACT AS A WEED SUPPRESSANT

7.5 WIND SCREENING
WIND SCREENING AND THE NEED FOR WIND BARRIERS SHOULD BE ASSESSED DURING THE MAINTENANCE PERIOD. WIND SCREENING SHOULD BE REMOVED AFTER 12 MONTHS TO ENSURE ALL PLANTS SUITABILITY HARDEN OFF TO THE ENVIRONMENT

7.6 RECORDS AND MONITORING
IT IS RECOMMENDED THAT ALL MANAGEMENT OPERATIONS UNDERTAKEN SHOULD BE RECORDED AND MAPPED. STANDARDIZED VEGETATION SURVEYS SHOULD BE UNDERTAKEN ANNUALLY TO MONITOR AND INFORM FUTURE MANAGEMENT DECISIONS. AS THE SITE MATURES MANAGEMENT REGIMES SHOULD BE ALTERED TO SUIT THE LANDSCAPES NATURALLY DESIGN EVOLUTION

7.10 DENR/DOP OVERSIGHT
THE DEPARTMENT OF PLANNING (DOP) AND/OR THE DEPARTMENT OF ENVIRONMENT AND NATURAL RESOURCES (DENR) SHALL REVIEW AND INSPECT CONSERVATION AREAS.

8.0 LONG TERM MANAGEMENT OBLIGATIONS

- REPLACING DEAD/DISEASED PLANTS
ALL REPLACEMENT PLANTING SHOULD BE PLANTED TO THE SAME SPECIFICATION AS THEY WERE ORIGINALLY SPECIFIED. IF REPLACEMENT IS REQUIRED AFTER MORE THEN 5 YEARS, PLANTINGS SHOULD REFLECT SIZES OF OTHER SIMILAR PLANTINGS ON SITE. SHOULD PLANTINGS OF A PARTICULAR SPECIES CONTINUE TO FAIL AT ANY GIVEN SITE OR HABITAT A MORE APPROPRIATE NATIVE SPECIES FOR THAT HABITAT SHOULD BE USED IN THEIR PLACE.
- MAKE RECORDS AND MONITOR THE ESTABLISHMENT OF NATIVE/ENDEMIC PLANTING AND CONSULT WITH THE LANDSCAPE ARCHITECT IF RECORDS INDICATE ANY ISSUES
- REMOVE WEEDS AND INVASIVE SPECIES THE FULL PLANT INCLUDING THE ROOT SYSTEM SHOULD BE REMOVED TO PREVENT RE-GROWTH. DO NOT USE STRIMMERS OR TILLERS.
- ENSURE ALL WEED AND INVASIVE SPECIES MATERIAL IS REMOVED FROM SITE TO PREVENT CONTAMINATION BY SEEDS. NON-INVASIVE PLANT MATERIAL CAN BE LEFT ON SITE FOR CHIPPING AND/OR DECOMPOSITION AND HABITAT CREATION FOR INSECTS, BACTERIA, AND OTHER MICROORGANISMS
- GRASS MOWING MUST BE COLLECTED RATHER THAN MULCHED TO PREVENT UNDUCE SPREAD OF ZOYSIA WITH ALL CLIPPINGS REMOVED TO A SUITABLE GREEN WASTE DISPOSAL FACILITY.
- MANAGEMENT PLAN REVIEWS SHOULD BE CARRIED OUT ANNUALLY BETWEEN APRIL AND JUNE. ADDITIONAL PLANTING AND CONTINUOUS MAINTENANCE ARE RECOMMENDED BEYOND THE TIME FRAME OF THIS MANAGEMENT PLAN

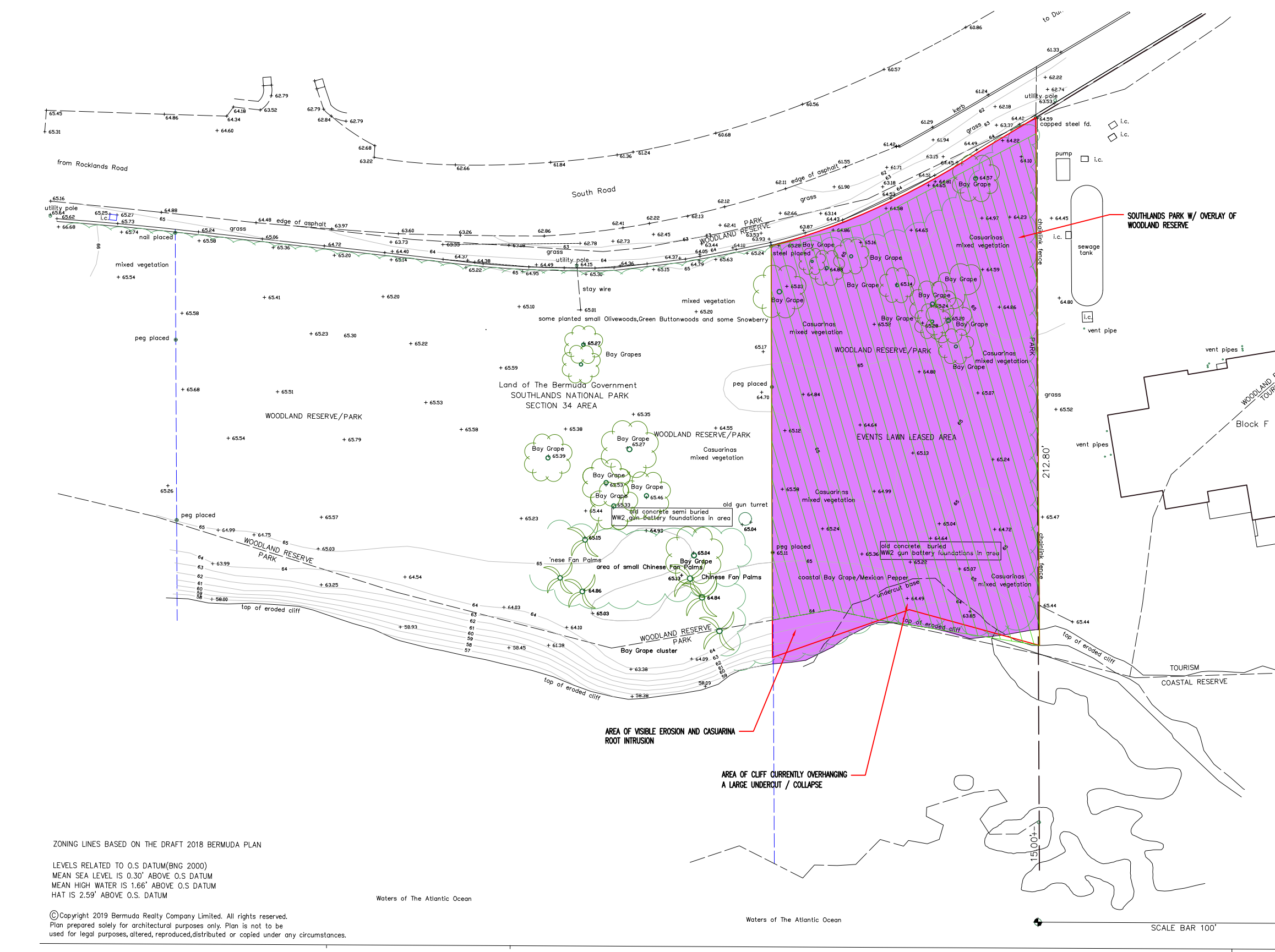

Suite 506, International Centre
26 Bermudiana Road
Hamilton HM 10
+1 441 373 5865
ck_la@outlook.com
www.ckla.com

PROJECT:
BERMUDIANA BEACH RESORT
MUNRO BEACH

60, SOUTH ROAD
WARWICK WK 08
BERMUDA

OWNER:
BERMUDA HOUSING CORPORATION
Seven Acres Building
44 Church Street East
Hamilton HM 10
+1 441 295 8823

ARCHITECTURE & ENGINEERING:
BRUNEL ENGINEERING
Suite 209, International Centre
26 Bermudiana Road
Hamilton HM 10
+1 441 297 6191

PROJECT MANAGER:
BCM CONSTRUCTION
48 St. Johns Road
Pembroke HM 07
+1 441 292 2286

SITE PLAN HAS BEEN PREPARED FROM ON A PROPERTY SURVEY. ALL DIMENSIONS TO BE VERIFIED ON SITE

SEAL

ISSUE	DESCRIPTION	DATE
#1	CMP PLANNING	12.09.2023

SCALE AS INDICATED
PROJECT # 014

DRAWING TITLE:
CONSERVATION MANAGEMENT PLAN

DRAWING NO:
L-001

SHEET:
EXISTING VEGETATION SURVEY

SHEET:

GENERAL NOTES:

- 1.) LOCATE AND VERIFY THE CONDITION OF EXISTING UTILITIES PRIOR TO EXCAVATION. TAKE RESPONSIBILITY OF CONTACTING LINE LOCATION SERVICES AND ANY COST INCURRED FOR BODILY INJURY AND / OR DAMAGE OF OWNER'S PROPERTY OR SAID UTILITIES.
- 2.) THE LANDSCAPE ARCHITECT SHALL BE NOTIFIED BY THE CONTRACTOR OF ANY DISCREPANCIES DISCOVERED BETWEEN THE PLANS AND ACTUAL SITE CONDITIONS BEFORE PROCEEDING WITH THE WORK. THE CONTRACTOR SHALL BE LIABLE FOR ALL MODIFICATIONS AND DAMAGES IF WORK PROCEEDS WITHOUT THIS NOTIFICATION AND APPROVAL.
- 3.) THE CONTRACTOR IS RESPONSIBLE FOR ALL ASPECTS OF MAINTAINING A SAFE WORK SITE INCLUDING BUT, NOT LIMITED TO PROVIDING FOR TRAFFIC CONTROL, INSTALLATION AND PLACEMENT OF FENCING AND BARRICADES, EXCAVATION AND TRENCH PROTECTION, AND COMPLIANCE WITH ALL FEDERAL AND LOCAL REGULATIONS AND CODES. ALL SAFETY EXPOSURES OR VIOLATIONS SHALL BE RECTIFIED IMMEDIATELY.
- 4.) THE CONTRACTOR IS RESPONSIBLE FOR PROTECTION OF ALL EXISTING IMPROVEMENTS BOTH ON SITE AND ADJACENT TO THE WORK SITE AND SHALL REPAIR ANY DAMAGE TO THESE IMPROVEMENTS TO THE SATISFACTION OF THE OWNER.
- 5.) THE CONTRACTOR SHALL NOTIFY OWNER AND LANDSCAPE ARCHITECT 72 HOURS PRIOR TO COMMENCEMENT OF WORK TO COORDINATE PROJECT INSPECTION SCHEDULES.
- 6.) ANY ALTERNATES AND OR SUBSTITUTIONS PROPOSED BY THE CONTRACTOR SHALL BE SUBMITTED TO THE LANDSCAPE ARCHITECT FOR APPROVAL. CHANGES TO THE SCOPE OF WORK AND / OR CONTRACT DOCUMENTS RESULTING FROM THE ACCEPTANCE OF THE CONTRACTOR'S ALTERNATES AND / OR SUBSTITUTIONS SHALL BE THE RESPONSIBILITY OF THE CONTRACTOR.
- 7.) THE CONTRACTOR IS RESPONSIBLE FOR REMOVAL OF TRASH ON A DAILY BASIS.
- 8.) THE CONTRACTOR SHALL COMPLY WITH ALL APPLICABLE CODES, REGULATIONS AND ORDINANCES. PRIOR TO CONSTRUCTION, ALL PERMITS AND APPROVALS REQUIRED FOR CONSTRUCTION OF THE PROJECT SHALL BE PAID FOR AND OBTAINED BY THE CONTRACTOR.
- 9.) COORDINATE WORK WITH SUBCONTRACTORS TO ACCOMPLISH THE SCOPE OF WORK AS SHOWN AND NOTED IN THE CONTRACT DOCUMENTS AS WELL AS, COORDINATE CONSTRUCTION WITH OTHER CONTRACTORS WORKING ON THE SITE.
- 10.) THE CONTRACTOR SHALL COORDINATE THE STORING OF MATERIALS, PARKING OF VEHICLES, AND RESTRICTIONS OF WORK AND ACCESS WITH THE OWNER. UNDER NO CIRCUMSTANCES SHALL ANY CONTRACTOR STORE MATERIALS, PARK VEHICLES OR EQUIPMENT UNDER THE CANOPY OF EXISTING TREES.
- 11.) UNLESS SPECIFIED OTHERWISE, THE CONTRACTOR IS RESPONSIBLE FOR PROVIDING AND PAYING ALL TEMPORARY UTILITIES AND SERVICES NECESSARY TO COMPLETELY INSTALL ALL WORK AS SHOWN AND NOTED IN THE CONTRACT DOCUMENTS.
- 12.) THE CONTRACTOR IS RESPONSIBLE FOR THE LEGAL OFF-SITE DISPOSAL OF SURPLUS MATERIAL AND DEBRIS.
- 13.) UPON COMPLETION OF CONSTRUCTION AND PRIOR TO FINAL APPROVAL, THE CONTRACTOR SHALL THOROUGHLY CLEAN THE PROJECT SITE OF ALL TRASH, REPAIR ALL DAMAGE TO FINISH GRADE, INCLUDING TAILINGS FROM EXCAVATIONS, WHEEL RUTS AND ANY SETTling OR EROSION THAT HAS OCCURRED PRIOR TO COMPLETION. ALL AREAS OF THE PROJECT SITE SHALL BE LEFT IN A NEAT AND PRESENTABLE CONDITION SATISFACTORY TO THE OWNER PRIOR TO SUBMITTAL OF THE FINAL PAYMENT.

LANDSCAPE GENERAL NOTES

BBR EVENT LAWN
CMP PLANTING SCHEDULE

SYMBOL	QTY	BOTANICAL NAME	COMMON NAME	SIZE
PALMS				
	6	Cocos nucifer	Coconut Palm	25 Gal
	9	Sabal Bermudiana	Bermuda Palmetto	10 Gal
	15			
TREES				
	12	Coccoloba uvifera	Bay Grape	25 Gal
	12			
SHRUBS				
	68	Carissa macrocarpa	Natal Plum	1 Gal
	180	Conocarpus erectus	Green Buttonwood	3 Gal
	64	Dodonea viscosa	Jamaican Dogwood	1 Gal
	312			

-  COCCOLOBA UVIFERA - BAY GRAPE
-  DODONEA VISCOSA - JAMAICAN DOGWOOD
-  SABAL BERMUDIANA - BERMUDA PALMETTO
-  CONOCARPUS ERECTUS - GREEN BUTTONWOOD
-  CARISSA MACROCARPA - NATAL PLUM

1 PLANTING PLAN CMP
L-003 1/16" = 1'-0"

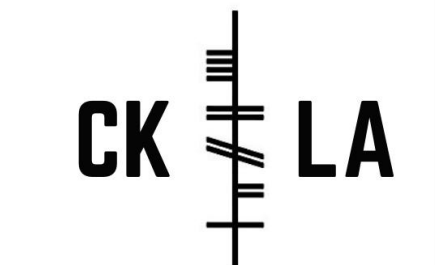
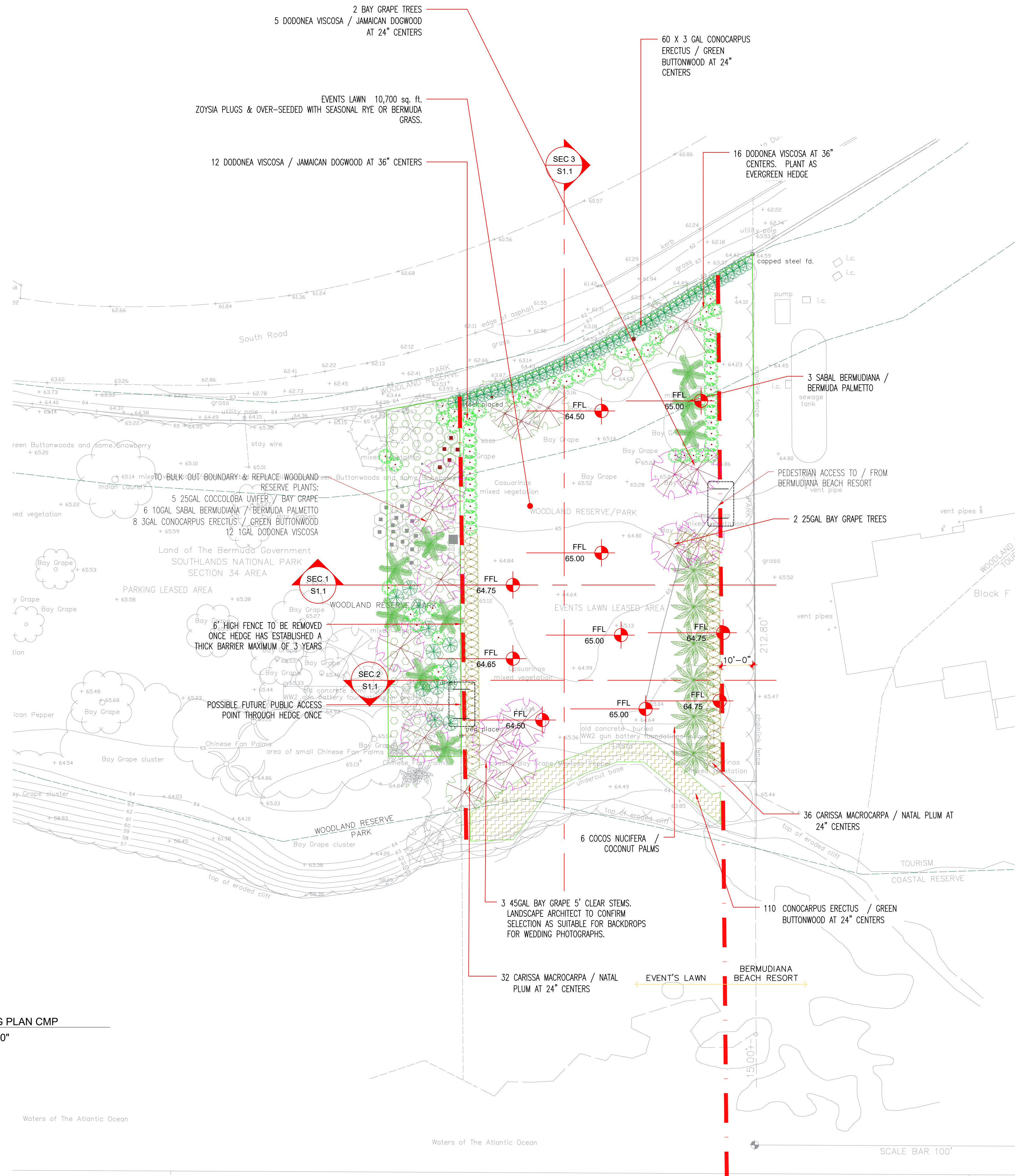

CK LANDSCAPE ARCHITECTURE & CONSULTANCY LTD

Suite 306, International Centre
28 Bermudiana Road
Hamilton HM 10
+1 441 373 9851
ck_la@outlook.com
www.ckla.com

PROJECT:
BERMUDIANA BEACH RESORT
MUNRO BEACH

60, SOUTH ROAD
WARWICK WK 08
BERMUDA

OWNER:
BERMUDA HOUSING CORPORATION
Seven Acres Building
44 Church Street East
Hamilton HM CA
+1 441 295 8823

ARCHITECTURE & ENGINEERING:
BRUNEL ENGINEERING
Suite 209, International Centre
28 Bermudiana Road,
Hamilton HM 10
+1 441 297 6191

PROJECT MANAGER:
BCM CONSTRUCTION
48 St. John's Road
Paradise HM 07
+1 441 292 2286

SITE PLAN HAS BEEN
PREPARED FROM ON A
PROPERTY SURVEY. ALL
DIMENSIONS TO BE VERIFIED
ON SITE



SEAL

ISSUE	DESCRIPTION	DATE
#1	CMP PLANNING	12.09.2023

SCALE AS INDICATED

PROJECT # 014

DRAWING TITLE:
**CONSERVATION
MANAGEMENT
PLAN**

DRAWING NO:

L-003

SHEET:

PROPOSED PLANTING
PLAN

SHEET:

PROPOSED EVENT'S LAWN FOR BERMUDIANA BEACH RESORT SOUTH ROAD, WARWICK PARISH, BERMUDA

JULY 2022

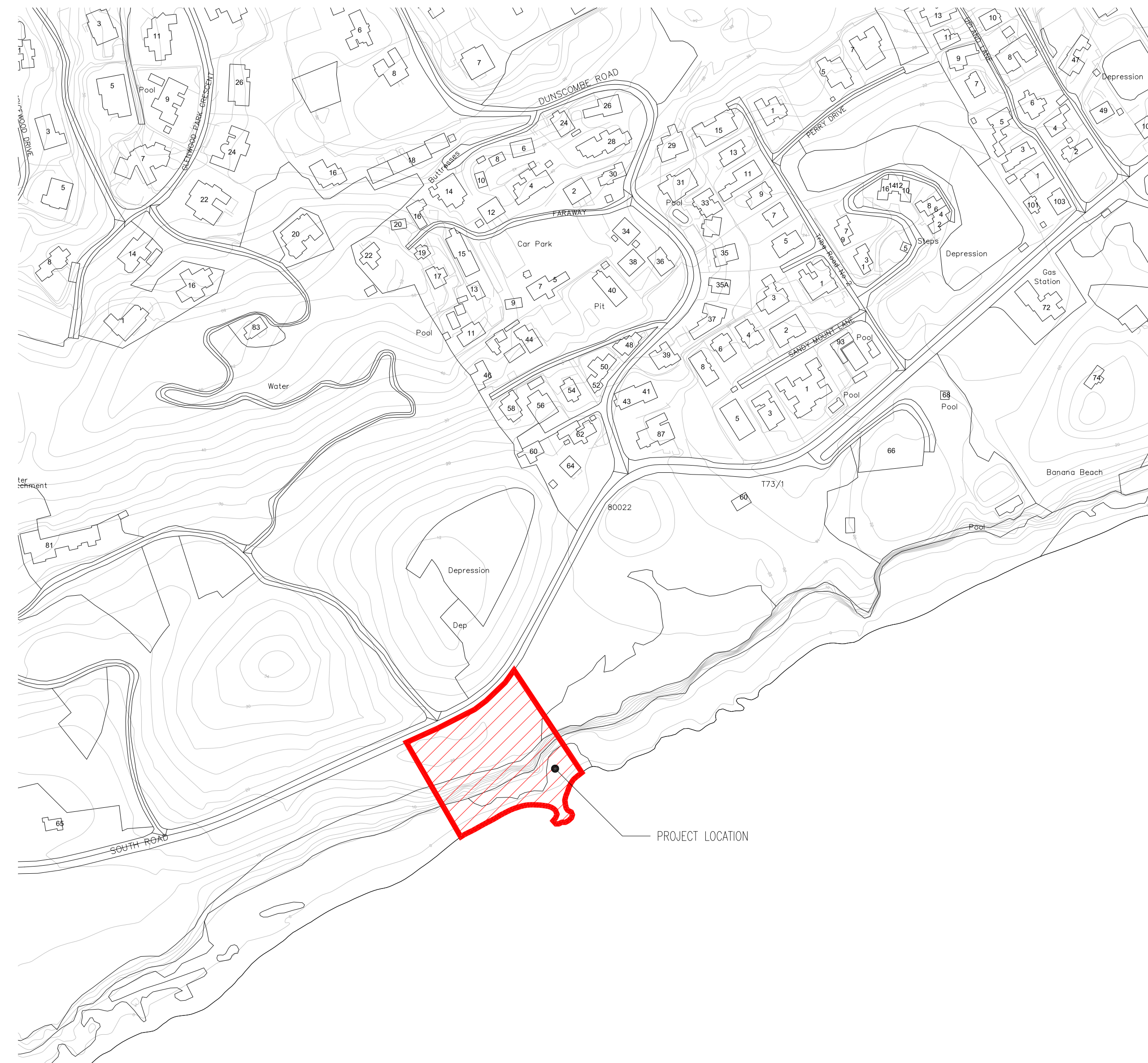

1 LOCATION PLAN
TP.0 SCALE: N.T.S.

SHEET INDEX	
SHEET #	SHEET TITLE
TP.0	TITLE SHEET / LOCATION PLAN / DRAWING SHEET LIST
SP.1	PROPOSED SITE, GRADING / EXCAVATION & LANDSCAPE PLANS
S.1	SECTIONS

3

DATE	NO.	REVISION
JUN. 2023	3	ISSUED REVISION AS CLOUDED
APR. 2023	2	ISSUED FOR APPEAL
MAR. 2023	1	ISSUED FOR ADDITIONAL INFO
JULY 2022	-	ISSUED DAP1 SUBMISSION

BRUNEL
ENGINEERING CONSULTANTS

t: 441.297.6191 • info@brunel.bm • www.brunel.bm

PROJECT:
BERMUDIANA BEACH RESORT
EVENT'S LAWN - SOUTH ROAD
WARWICK PARISH

TITLE:
TITLE PAGE /
LOCATION PLAN /
DRAWING LIST

SCALE:	AS SHOWN	JOB NO:	21-087
DRAWN BY:	JC	DRAWING #:	TP.0
DATE:	JULY 2022		

DRAWING SCALE SHOWN IS FOR FULL-SIZE DRAWINGS. DRAWINGS PLOTTED ON 11"x17" SHEETS ARE HALF SCALE SHOWN (1/4"=1'-0" ON 24"x36" SHEET = 1/8"=1'-0" ON 11"x17" SHEET)

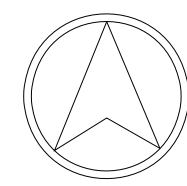

3

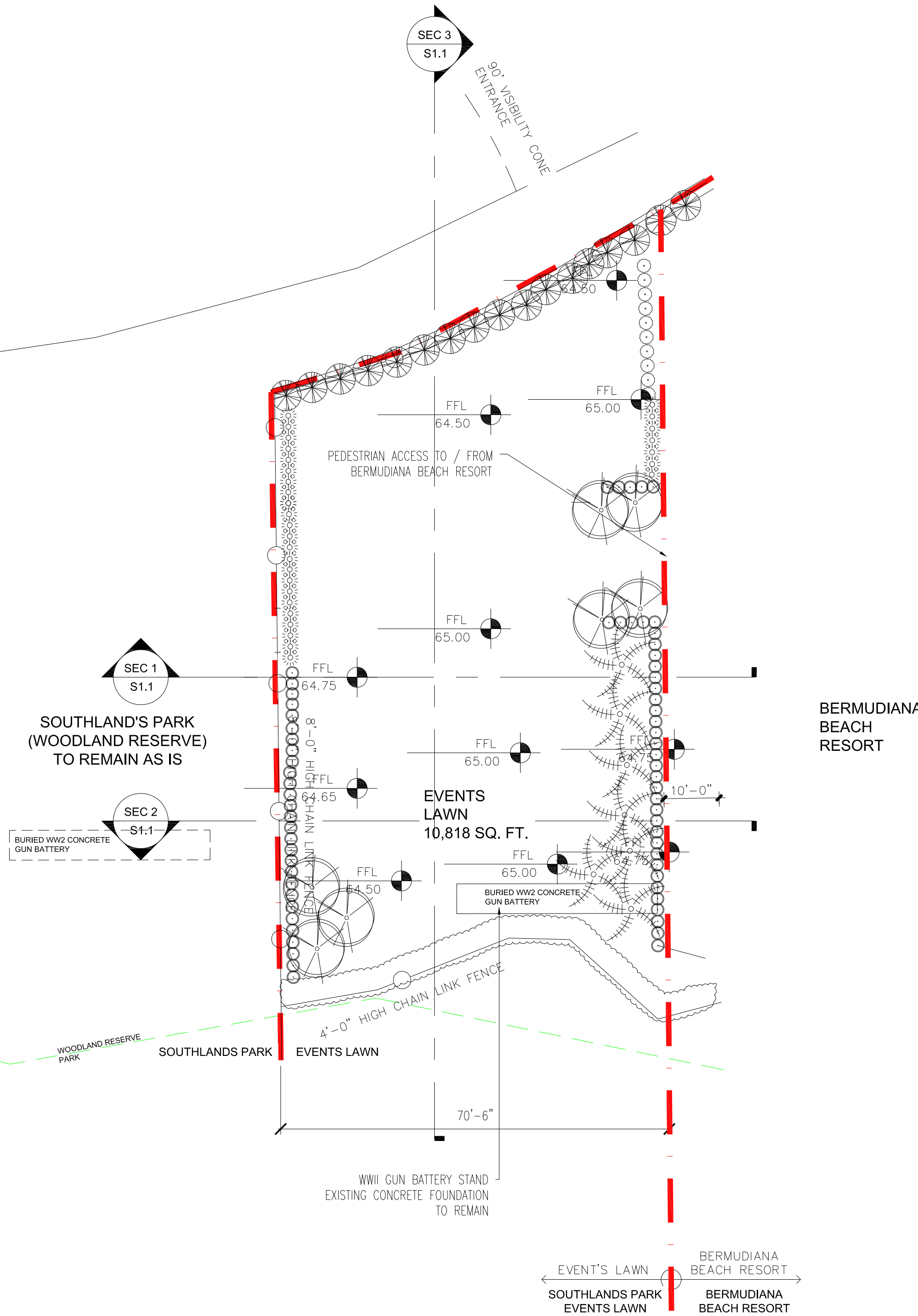

1 SITE PLAN
 SCALE: 1/8" = 1'-0" (11"x17" SHEET)
 1/16" = 1'-0" (24"x36" SHEET)

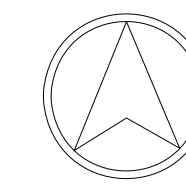

3

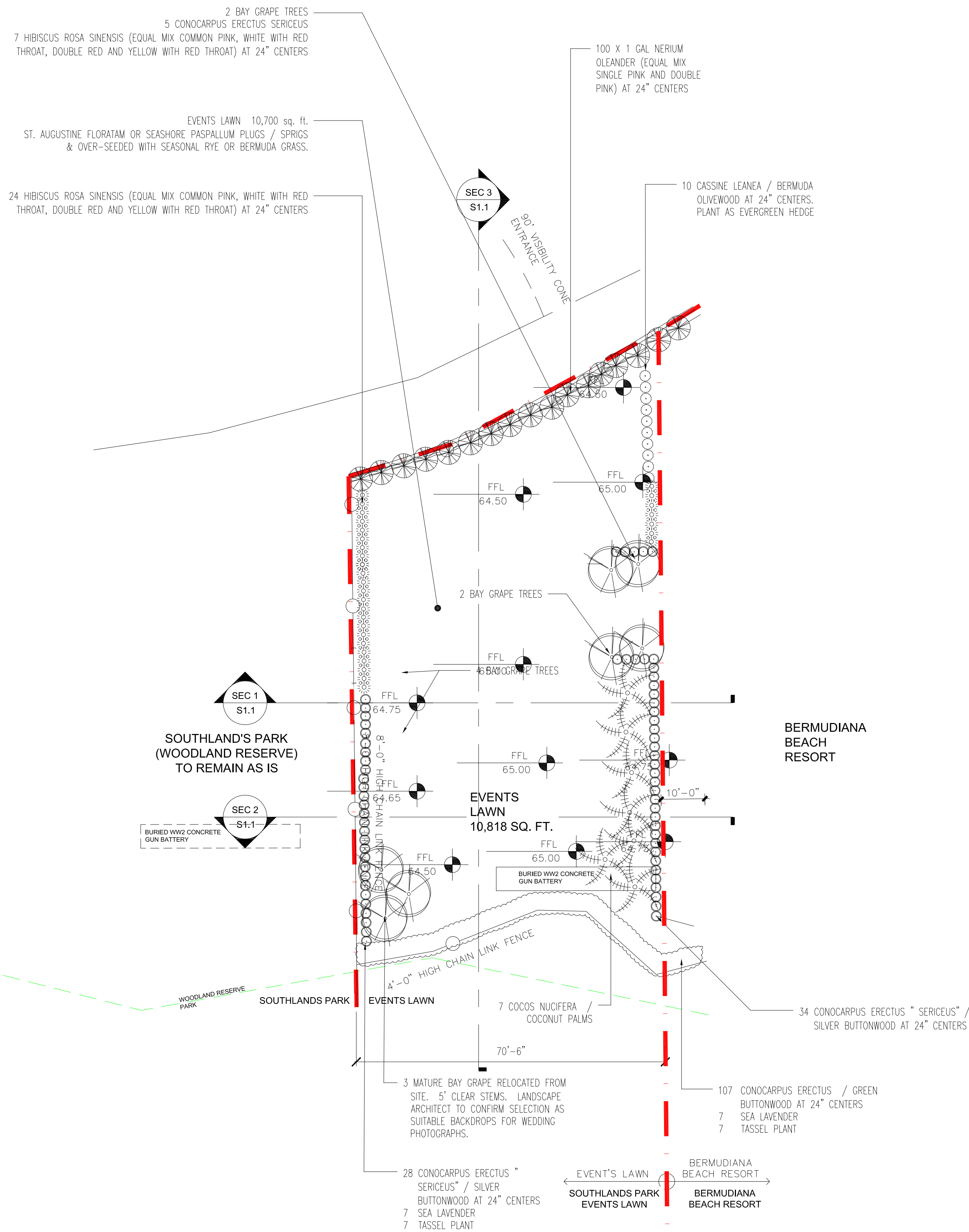

2 LANDSCAPE PLAN
 SCALE: 1/8" = 1'-0" (11"x17" SHEET)
 1/16" = 1'-0" (24"x36" SHEET)

LEGEND

- BBR BOUNDARY LINE
- EXTENT OF LEASED LAND
- EXTENT OF LEASED LAND
- CHAIN LINK FENCE 8'
- EXTENT OF PUBLIC PARKING
- EXTENT OF EVENTS LAWN
- ELECTRIC CAR CHARGE STATION
- GEO-CELL GRID WITH TURF COVER
- ASPHALT
- CONCRETE
- GRASS LAWN
- MATURE BAY GRAPE (COCOLOBA UVIFERA) RELOCATED FROM SITE
- PALMS
- OLEANDER HEDGE
- SUB-SHRUBS AND GROUND COVER
- SHRUBS

DATE	NO.	REVISION
JUN. 2023	3	ISSUED REVISION AS CLOUDED
APR. 2023	2	ISSUED FOR APPEAL
MAR. 2023	1	ISSUED REVISION AS CLOUDED
JULY 2022	-	ISSUED DAP1 SUBMISSION



t: 441.297.8191 • info@brunel.bm • www.brunel.bm

PROJECT:
 BERMUDEANA BEACH RESORT
 EVENT'S LAWN - SOUTH ROAD
 WARWICK PARISH

TITLE:
 PROPOSED SITE,
 GRADING / EXCAVATION
 & LANDSCAPE PLANS

SCALE: AS SHOWN	JOB NO: 21-087
DRAWN BY: JC	DRAWING #:
DATE: JULY 2022	SP.1

DRAWING SCALE SHOWN IS FOR FULL-SIZE DRAWINGS. DRAWINGS PLOTTED ON 11"x17" SHEETS ARE HALF SCALE SHOWN (1/4"=1'-0" ON 24"x36" SHEET = 1/8"=1'-0" ON 11"x17" SHEET)

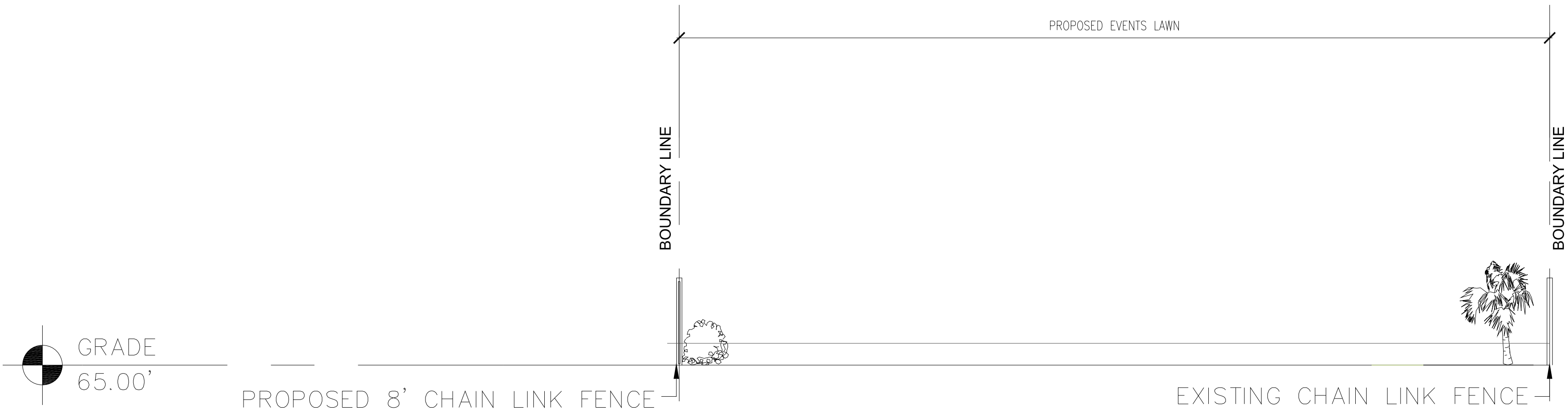

1 SECTION
 S.1 SCALE: 1/32" = 1'-0" (11"x17" SHEET)
 1/16" = 1'-0" (24"x36" SHEET)

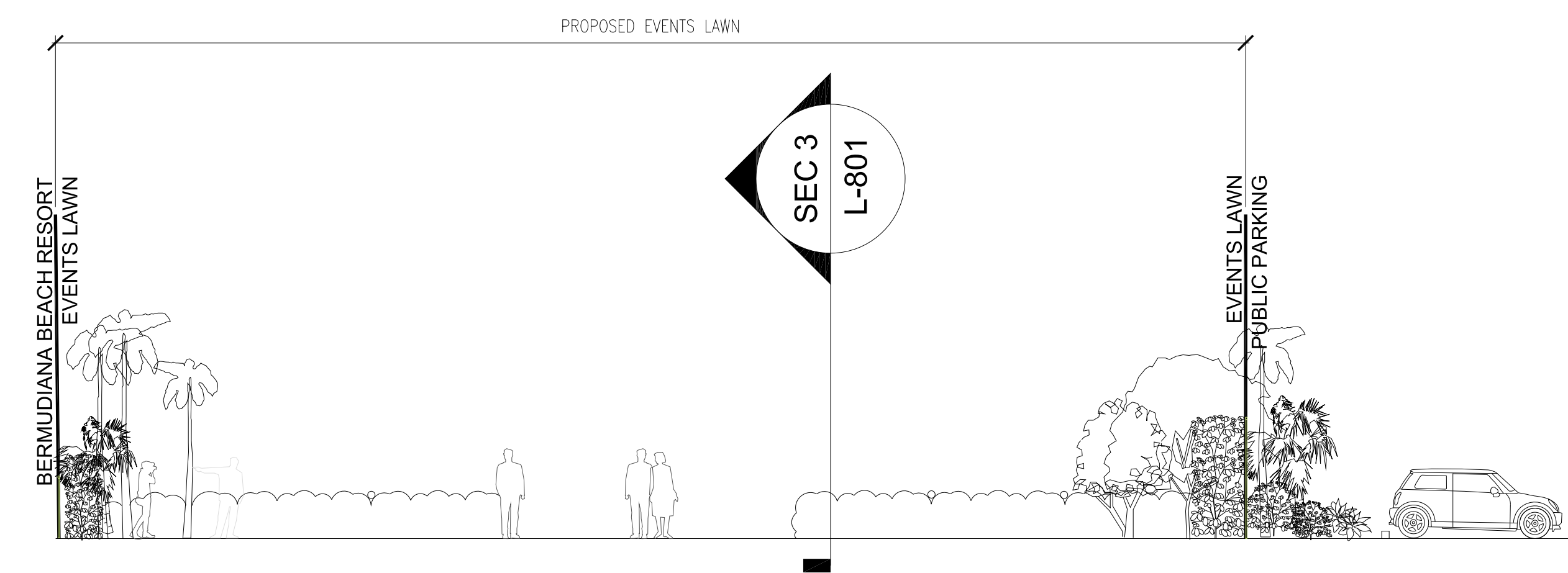

2 SECTION
 S.1 SCALE: 1/32" = 1'-0" (11"x17" SHEET)
 1/16" = 1'-0" (24"x36" SHEET)

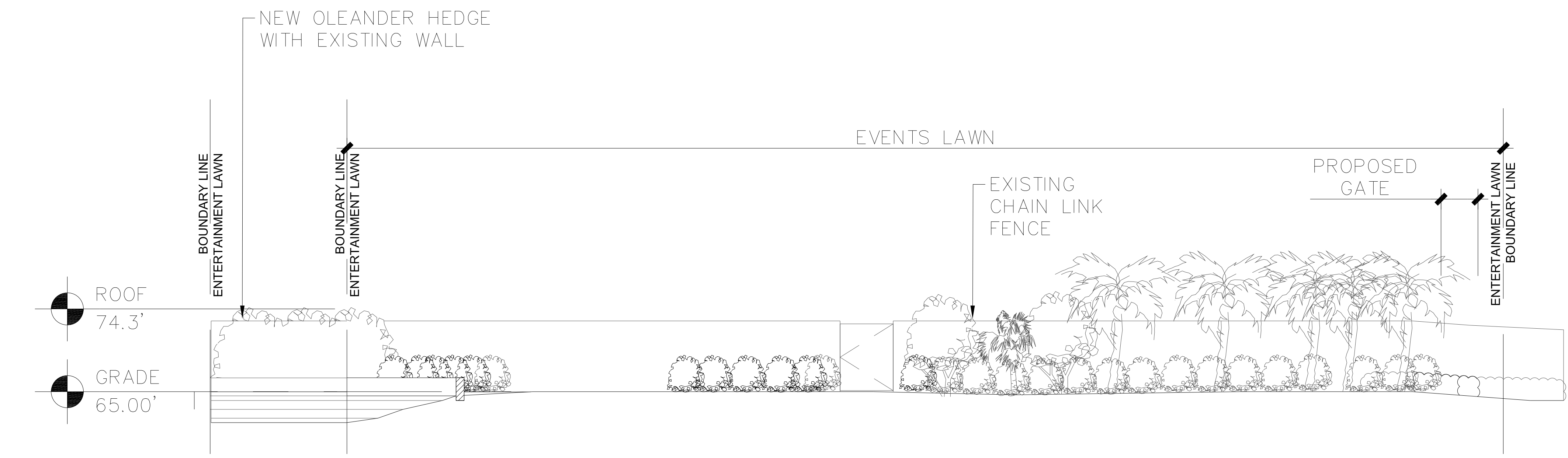

3 SECTION
 S.1 SCALE: 1/32" = 1'-0" (11"x17" SHEET)
 1/16" = 1'-0" (24"x36" SHEET)

LEGEND

- BBR BOUNDARY LINE
- EXTENT OF LEASED LAND
- EXTENT OF LEASED LAND
- CHAIN LINK FENCE 8'
- EXTENT OF PUBLIC PARKING
- EXTENT OF EVENTS LAWN
- ELECTRIC CAR CHARGE STATION
- ▨ GEO-CELL GRID WITH TURF COVER
- ▨ ASPHALT
- ▨ CONCRETE
- ▨ GRASS LAWN
- MATURE BAY GRAPE (COCOLOBA UVIFERA) RELOCATED FROM SITE
- PALMS
- OLEANDER HEDGE
- SUB-SHRUBS AND GROUND COVER
- SHRUBS



JUN. 2023	3	ISSUED REVISION AS CLOUDED
APR. 2023	2	ISSUED FOR APPEAL
MAR. 2023	1	ISSUED REVISION AS CLOUDED
JULY 2022	-	ISSUED DAP1 SUBMISSION
DATE	NO.	REVISION

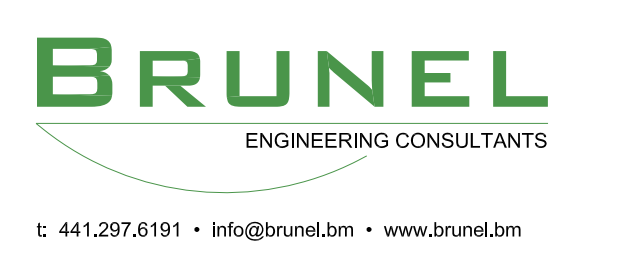

PROJECT:
 BERMUDIANA BEACH RESORT
 EVENT'S LAWN - SOUTH ROAD
 WARWICK PARISH

TITLE:
 SECTIONS

SCALE:	AS SHOWN	JOB NO:	21-087
DRAWN BY:	JC	DRAWING #:	S.1
DATE:	JULY 2022		

DRAWING SCALE SHOWN IS FOR FULL-SIZE DRAWINGS. DRAWINGS PLOTTED ON 11"x17" SHEETS ARE HALF SCALE SHOWN (1/4"=1'-0" ON 24"x36" SHEET = 1/8"=1'-0" ON 11"x17" SHEET)