

Island Plan

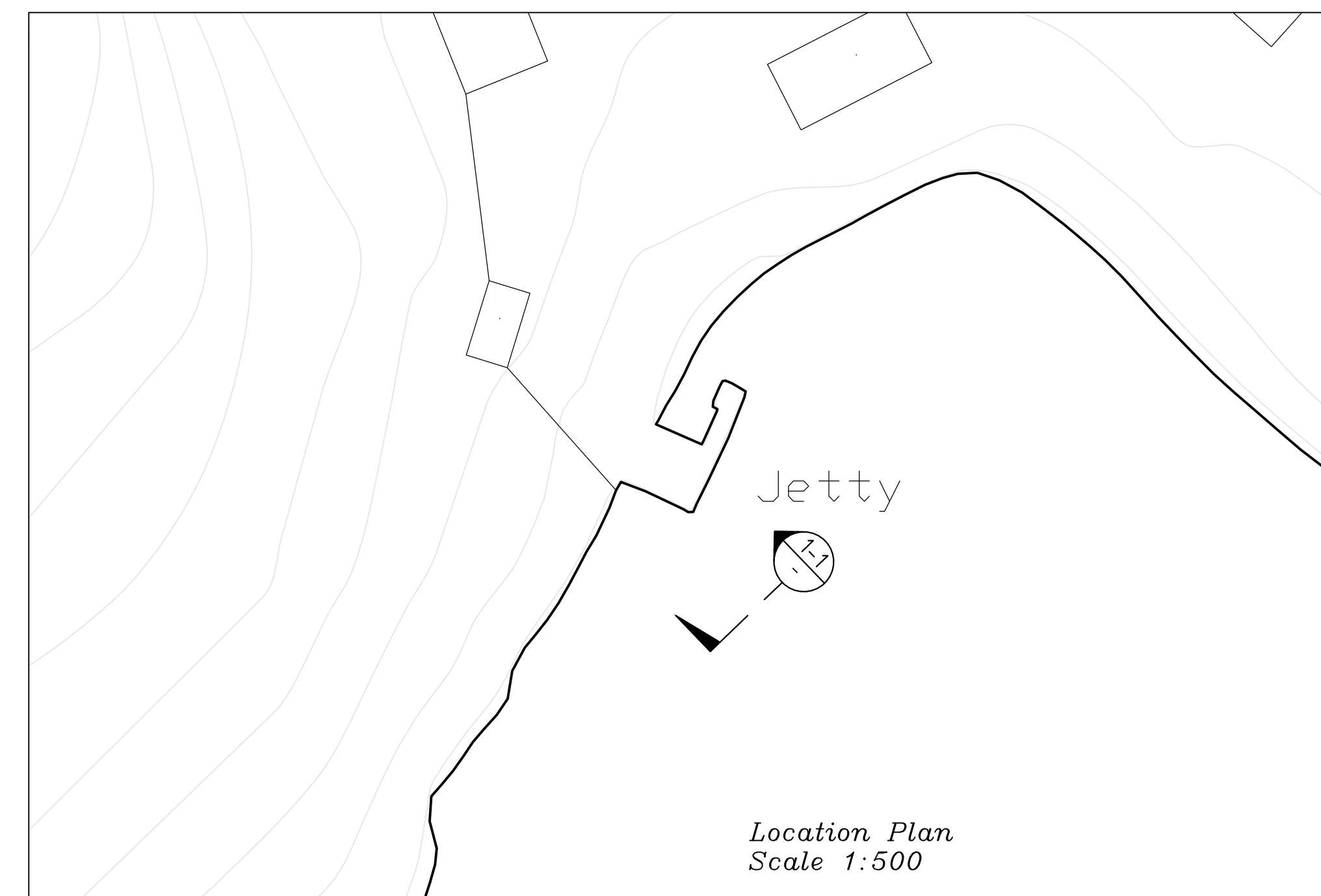

Location Plan  
Scale 1:500

ISSUED FOR: INFORMATION

| AMENDMENTS: |            |          |
|-------------|------------|----------|
| NO:         | REVISION   | DATE:    |
| A           | FOR TENDER | 16/09/24 |
|             |            |          |
|             |            |          |
|             |            |          |
|             |            |          |

SCALE: AS SHOWN AT ANSI D

SURVEY  
PREPARED: - DATE: XX/XX/XXXX

DESIGN  
PREPARED: DATE: DATE:  
CHECKED: A.KENNY DATE: 16/09/2024

DRAWING  
PREPARED: C.FRASER DATE: 16/09/2024  
CHECKED: A.KENNY DATE: 16/09/2024

APPROVED BY:  
A.KENNY - PRINC. STRUCTURAL ENGINEER

PROJECT NUMBER:

PROJECT NAME:  
**PORTS ISLAND  
DOCK  
REPAIRS 2024**

SHEET TITLE:  
**LOCATION PLAN**

SHEET NUMBER:  
**S001**

REVISION  
**A**



VIEW 1-1  
VIEW ON PORTS ISLAND DOCK

GENERAL

- ALL DRAWINGS SHALL BE READ IN CONJUNCTION WITH THE SPECIFICATION AND ANY OTHER WRITTEN INSTRUCTIONS ISSUED.
- WHERE APPROVAL IS REQUIRED, THIS SHALL BE OF THE SUPERINTENDENT OR HIS REPRESENTATIVE.
- ANY AMBIGUITY OR DISCREPANCY SHALL BE REFERRED FOR CLARIFICATION BEFORE WORK PROCEEDS.
- DIMENSIONS ARE IN PRESENTED MILLIMETERS WITH EQUIVALENT INCH VALUE SHOWN IN BRACKETS.  
EXAMPLE: 1000mm (40")
- FOR SPECIFIC ITEMS AND MEASUREMENTS, DIMENSIONS ARE ALSO PROVIDED IN INCHES TO ASSIST PURCHASING AND CLEARLY LABELED WITH " IDENTIFIER.
- REFER TO THE DRAWING DIMENSIONS FOR SETTING OUT THE WORKS. HOWEVER, ALL EXISTING DIMENSIONS AND LEVELS ARE APPROXIMATE AND SHALL BE CONFIRMED BY THE CONTRACTOR ON SITE.
- UNLESS NOTED OTHERWISE, ALL LEVELS ARE TO OD. SET OUT IS TO BNG 2000.
- THE CONTRACTOR SHALL BE RESPONSIBLE FOR MAINTAINING THE STABILITY OF THE STRUCTURE UNTIL ITS COMPLETION AND SHALL ENSURE THAT NO PART OF THE STRUCTURE IS OVERSTRESSED DURING THE WORKS.
- WHERE STANDARDS ARE REFERRED TO, THEY SHALL BE THE LATEST EDITION.
- PROPRIETARY ITEMS, PROPOSED BY THE CONTRACTOR, ARE TO BE REVIEWED AND APPROVED BY THE DESIGNING ENGINEER PRIOR TO USE.
- THE CONTRACTOR SHALL BE RESPONSIBLE FOR SECURING WORK AREAS.
- ALL DEMOLITION SHALL BE IN AN ACCEPTABLE MANNER UNDER THE OCCUPATIONAL HEALTH AND SAFETY REGULATIONS 2009. ALL SURPLUS MATERIAL SHALL BE DISPOSED OF OFF SITE IN A LEGAL MANNER.

CONCRETE

- CONCRETE SHALL COMPLY WITH THE FOLLOWING SPECIFICATION:
  - MINIMUM CONCRETE COVER TO REINFORCEMENT INFILLS  
TOP, BOTTOM & SIDES = 75mm (3")
  - MINIMUM CONCRETE STRENGTH AT SERVICE  $F'c = 25 \text{ MPa}$
  - MINIMUM CEMENT CONTENT =  $440 \text{ Kg/m}^3 (28 \text{ lb/ft}^3)$
  - MAXIMUM WATER/CEMENT RATIO = 0.5
- CONCRETE MIX DESIGNS TO BE SUBMITTED TO THE ENGINEER FOR APPROVAL.
- NO ADDITIVES TO BE USED WITHOUT THE PRIOR APPROVAL OF THE ENGINEER.
- CAST IN ITEMS WITH LESS THAN 25mm (1") COVER TO ATMOSPHERE SHALL BE HOT DIPPED GALVANISED IN ACCORDANCE WITH ASTM A153.
- ALL FORMWORK, SHORING AND RESHORING SHALL BE THE RESPONSIBILITY OF AND DESIGNED BY THE CONTRACTOR
- CONCRETE SHALL BE TESTED FOR SLUMP ON SITE. THE TEST CYLINDERS SHALL BE TAKEN FOR 3, 7 AND 28 DAY STRENGTHS.
- CONCRETE STRENGTH AND SLUMP TO BE AS FOLLOWS

| MIN. SPECIFIED 28 DAY STRENGTH | SLUMP       |
|--------------------------------|-------------|
| 25 MPa                         | 75mm ± 25mm |

REINFORCEMENT

- WELDING OF REINFORCEMENT SHALL NOT BE PERMITTED UNLESS SHOWN ON THE STRUCTURAL DRAWINGS. IF SHOWN/PERMITTED, WELDS SHALL DEVELOP THE FULL STRENGTH OF THE REINFORCING ELEMENT.
- ALL REINFORCING STEEL TO HAVE A MINIMUM YIELD STRENGTH OF 410 MPa AND SHALL BE TYPE 2 DEFORMED BARS
- ALL REINFORCING STEEL SHALL BE CLASS II GALVANISED IN ACCORDANCE WITH ASTM A767. TIE WIRE SHALL ALSO BE GALVANISED.
- REINFORCEMENT SPACING NOT SHOWN SHALL BE TAKEN AS EQUAL.
- REINFORCING CHAIRS ARE TO BE CONCRETE AND AS SMALL AS PRACTICABLE. PROPRIETARY PLASTIC COVER SUPPORTS MAY BE USED WITH THE APPROVAL OF THE ENGINEER.
- REINFORCING BARS SHOWN ON THESE DRAWINGS ARE DIAGRAMMATIC ONLY.
- BARS SHOWN MAY REPRESENT MORE THAN ONE LENGTH AND/OR PROFILE.
- BARS MAY NOT BE SHOWN IN TRUE POSITION FOR CLARITY. ALL HOOKS, BENDS AND COGS ARE STANDARD AND SHALL BE IN ACCORDANCE WITH ACI 318 UNLESS NOTED OTHERWISE.
- LAP SPLICES TO ALTERNATE AND NO MORE THAN 50% OF SPLICES SHALL BE IN ANY ONE SECTION.
- BARS SHALL NOT BE CUT NOR BENT ON SITE WITHOUT THE PRIOR APPROVAL OF THE ENGINEER.
- BARS SHALL BE BENT COLD BY MACHINE OR OTHER APPROVED MEANS PRODUCING A GRADUAL AND EVEN MOTION. BARS INCORRECTLY BENT SHALL NOT BE RE-BENT AND INCORPORATED IN THE WORKS AND NO REINFORCEMENT SHALL BE BENT WHEN IN POSITION IN THE WORKS, WHETHER OR NOT IT IS PARTIALLY EMBEDDED IN HARDENED CONCRETE.
- CONTRACTOR TO PROVIDE 24 HOURS NOTICE FOR THE INSPECTION OF ALL REINFORCING PRIOR TO POURING CONCRETE.
- LAP LENGTHS SHALL BE AS TABULATED (SHOWN TO THE RIGHT) UNLESS SHOWN OTHERWISE ON THE DRAWINGS.

| MINIMUM ALLOWABLE LAP LENGTHS |                |
|-------------------------------|----------------|
| BAR DIAMETER                  | MIN LAP LENGTH |
| T10                           | 460mm [18"]    |
| T12                           | 600mm [24"]    |
| T16                           | 760mm [30"]    |
| T20                           | 900mm [36"]    |
| T25                           | 1500mm [60"]   |

| ALTERNATIVE BAR SIZES |                         |                             |
|-----------------------|-------------------------|-----------------------------|
| METRIC BAR SIZE (mm)  | IMPERIAL EQUIVALENT (") | FORMER IMPERIAL DESIGNATION |
| T10                   | 3/8"                    | #3                          |
| T12                   | 1/2"                    | #4                          |
| T16                   | 5/8"                    | #5                          |
| T20                   | 3/4"                    | #6                          |
| T25                   | 1"                      | #8                          |



NOTES

- REFER TO SHEET S001 FOR DRAWING NOTES

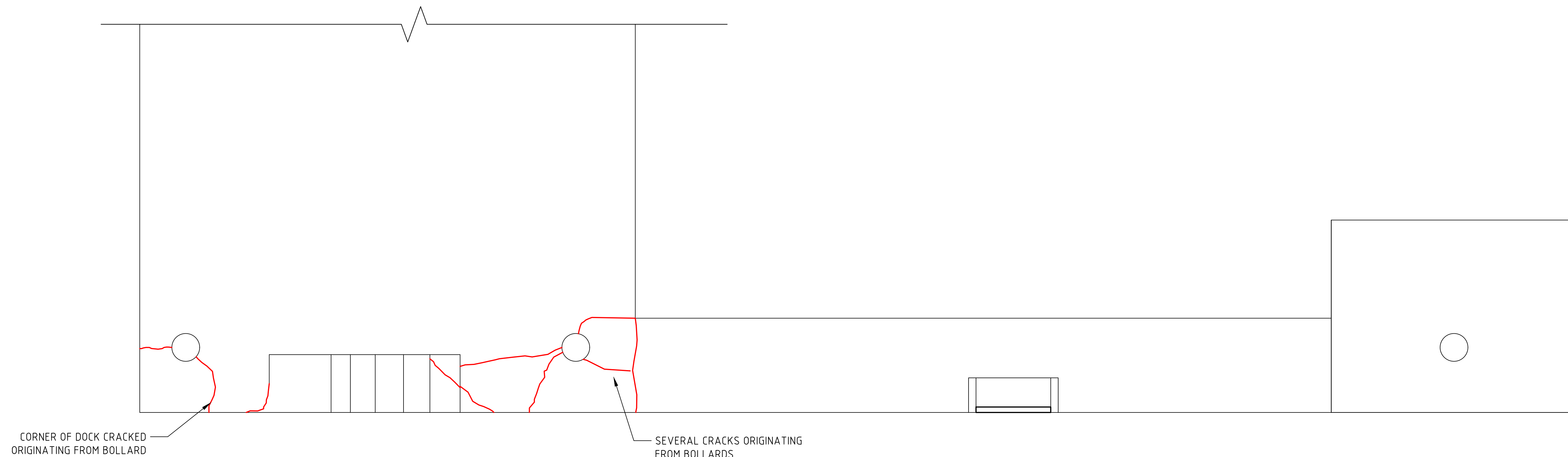

EXISTING CONDITION OF DOCK  
PLAN VIEW

1:40

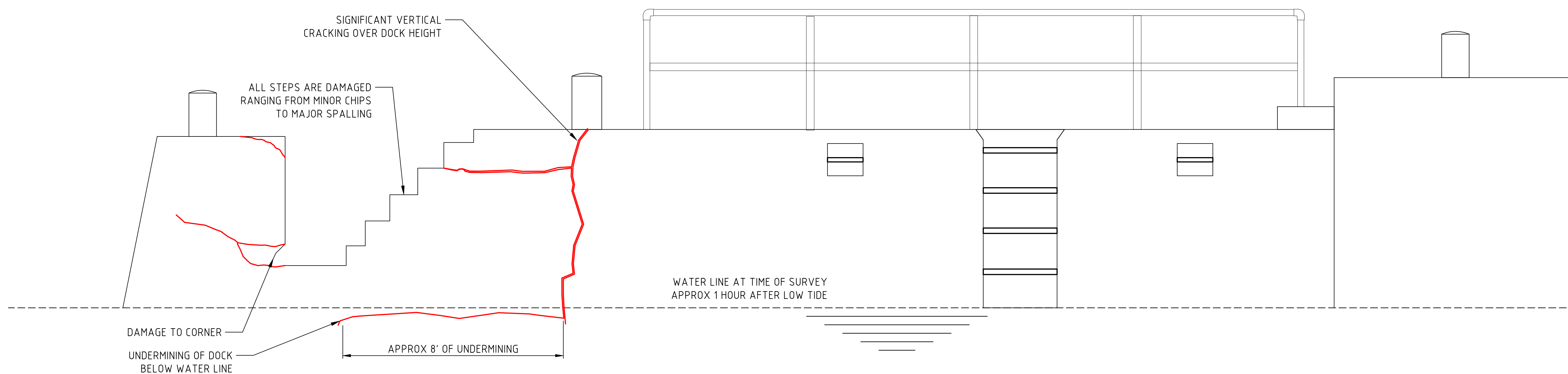

EXISTING CONDITION OF DOCK  
ELEVATION ON EAST FACE

1:40

ISSUED FOR: INFORMATION

| AMENDMENTS: |            |          |
|-------------|------------|----------|
| NO:         | REVISION   | DATE:    |
| A           | FOR TENDER | 16/09/24 |
|             |            |          |
|             |            |          |
|             |            |          |
|             |            |          |

SCALE: AS SHOWN AT ANSI D

SURVEY  
PREPARED: - DATE:

DESIGN  
PREPARED: - DATE:  
CHECKED: A.KENNY DATE:

DRAWING  
PREPARED: C.FRASER DATE: 16/09/2024  
CHECKED: A.KENNY DATE: 16/09/2024

APPROVED BY:  
A.KENNY - PRINC STRUCTURAL ENGINEER  
PROJECT NUMBER:

PROJECT NAME:  
**PORTS ISLAND  
DOCK  
REPAIRS 2024**

SHEET TITLE:  
**EXISTING CONDITION**

SHEET NUMBER: **S002** REVISION: **A**

NOTES

- REFER TO SHEET S001 FOR DRAWING NOTES

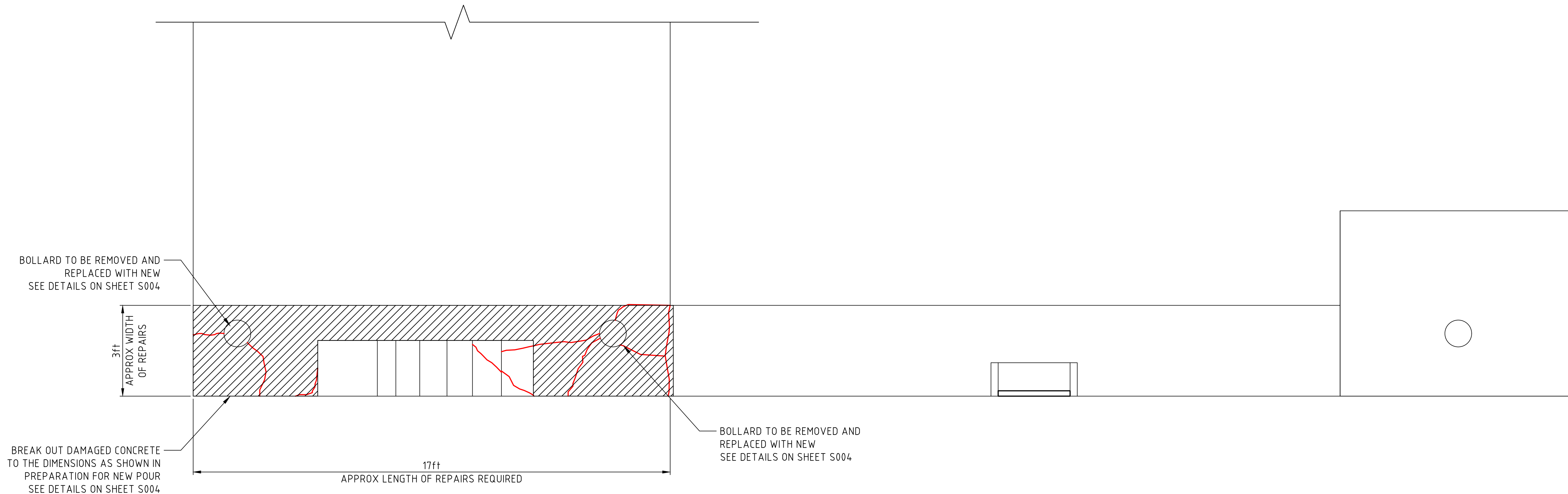

AREA OF EXISTING DOCK TO BE DEMOLISHED  
PLAN VIEW

1:40

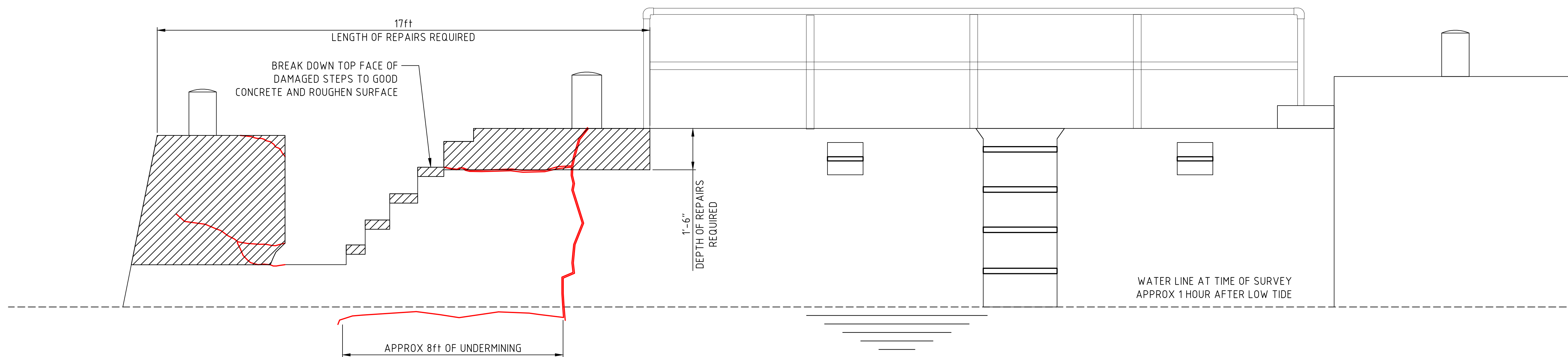

AREA OF EXISTING DOCK TO BE DEMOLISHED  
ELEVATION ON EAST FACE

1:40

ISSUED FOR: INFORMATION

| AMENDMENTS: |            |          |
|-------------|------------|----------|
| NO:         | REVISION   | DATE:    |
| A           | FOR TENDER | 16/09/24 |
|             |            |          |
|             |            |          |
|             |            |          |
|             |            |          |

SCALE: AS SHOWN AT ANSI D

SURVEY  
PREPARED: - DATE: XX/XX/XXXX

DESIGN  
PREPARED: DATE:  
CHECKED: DATE:

DRAWING  
PREPARED: C.FRASER DATE: 16/09/2024  
CHECKED: A.KENNY DATE: 16/09/2024

APPROVED BY:  
A.KENNY - PRINC STRUCTURAL ENGINEER  
PROJECT NUMBER:

PROJECT NAME:  
**PORTS ISLAND  
DOCK  
REPAIRS 2024**

SHEET TITLE:  
**PROPOSED DEMOLITION**

SHEET NUMBER: **S003** REVISION: **A**

NOTES

- REFER TO SHEET S001 FOR DRAWING NOTES

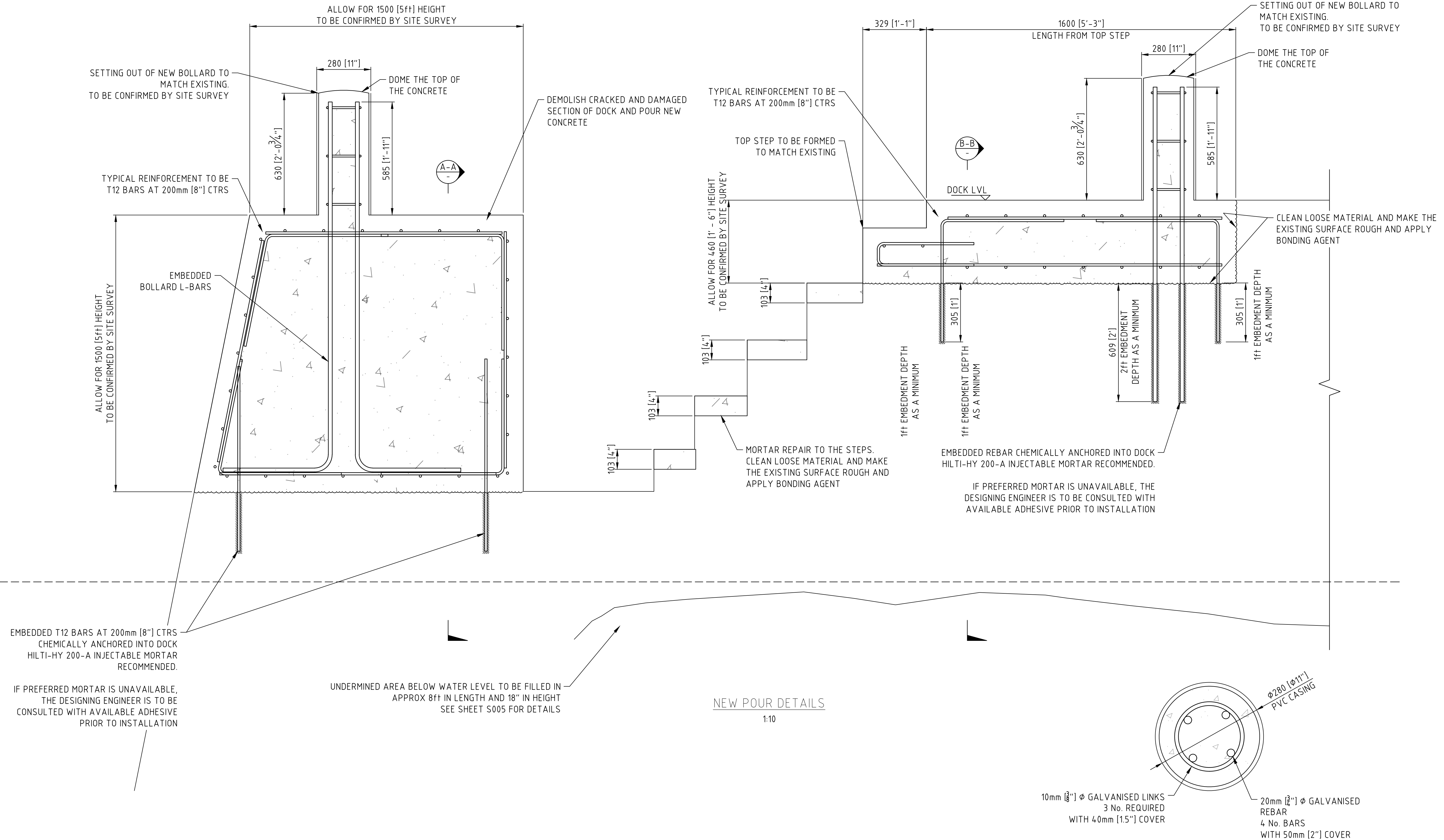

ISSUED FOR: INFORMATION

| AMENDMENTS: |            |          |
|-------------|------------|----------|
| NO:         | REVISION   | DATE:    |
| A           | FOR TENDER | 16/09/24 |
|             |            |          |
|             |            |          |
|             |            |          |
|             |            |          |

SCALE: AS SHOWN AT ANSI D

SURVEY  
PREPARED: - DATE: XX/XX/XXXX

DESIGN  
PREPARED: DATE: 16/09/2024  
CHECKED: A.KENNY DATE: 16/09/2024

DRAWING  
PREPARED: C.FRASER DATE: 16/09/2024  
CHECKED: A.KENNY DATE: 16/09/2024

APPROVED BY: PRINC STRUCTURAL ENGINEER  
PROJECT NUMBER: -

PROJECT NAME:  
**PORTS ISLAND  
DOCK  
REPAIRS 2024**

SHEET TITLE:  
**NEW CONCRETE POUR  
DETAILS**

SHEET NUMBER: **S004** REVISION: **A**

NEW BOLLARD DETAIL

1:5

NEW POUR DETAILS

1:10

NOTES

- REFER TO SHEET S001 FOR DRAWING NOTES

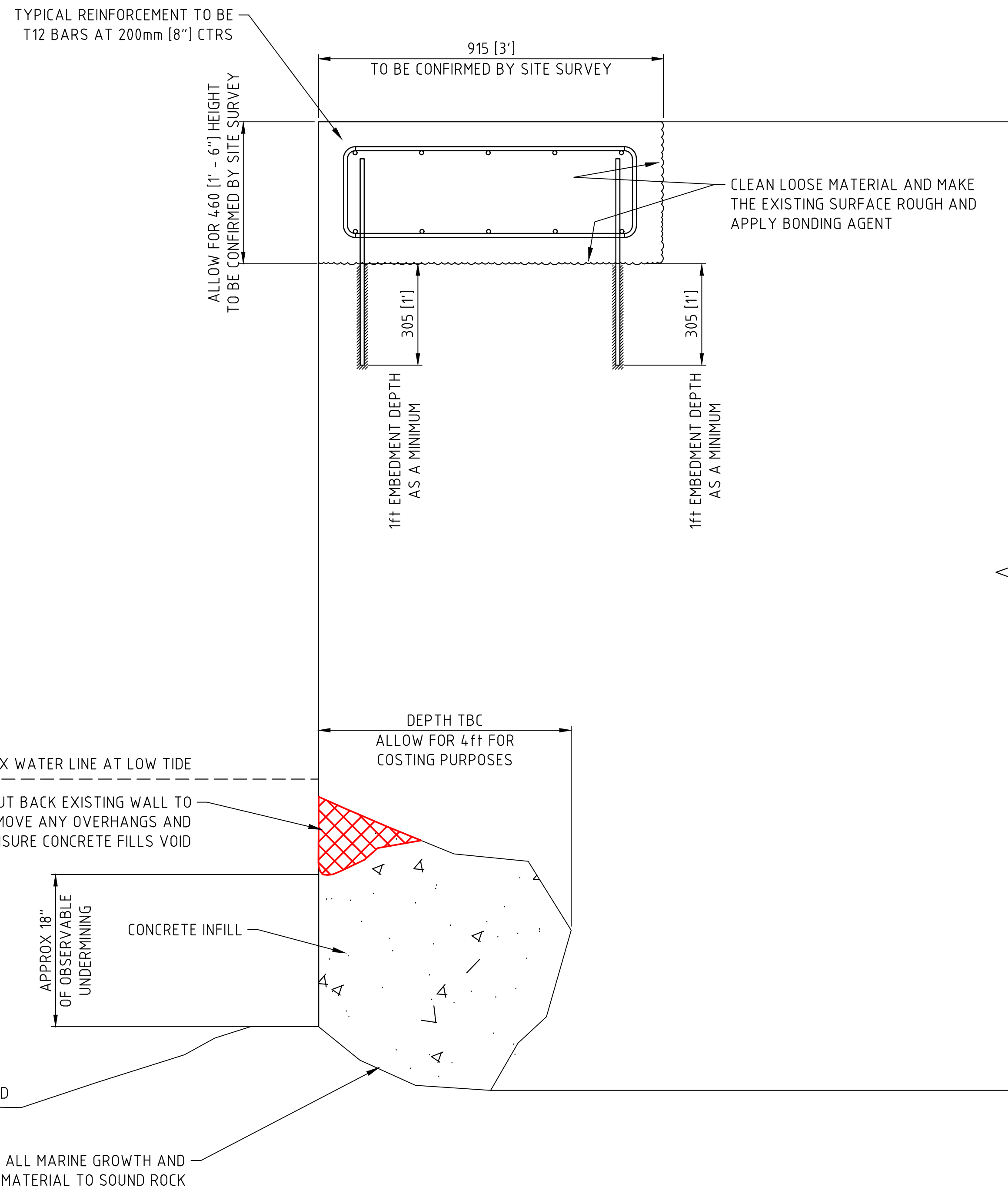

SECTION A-A  
1:10

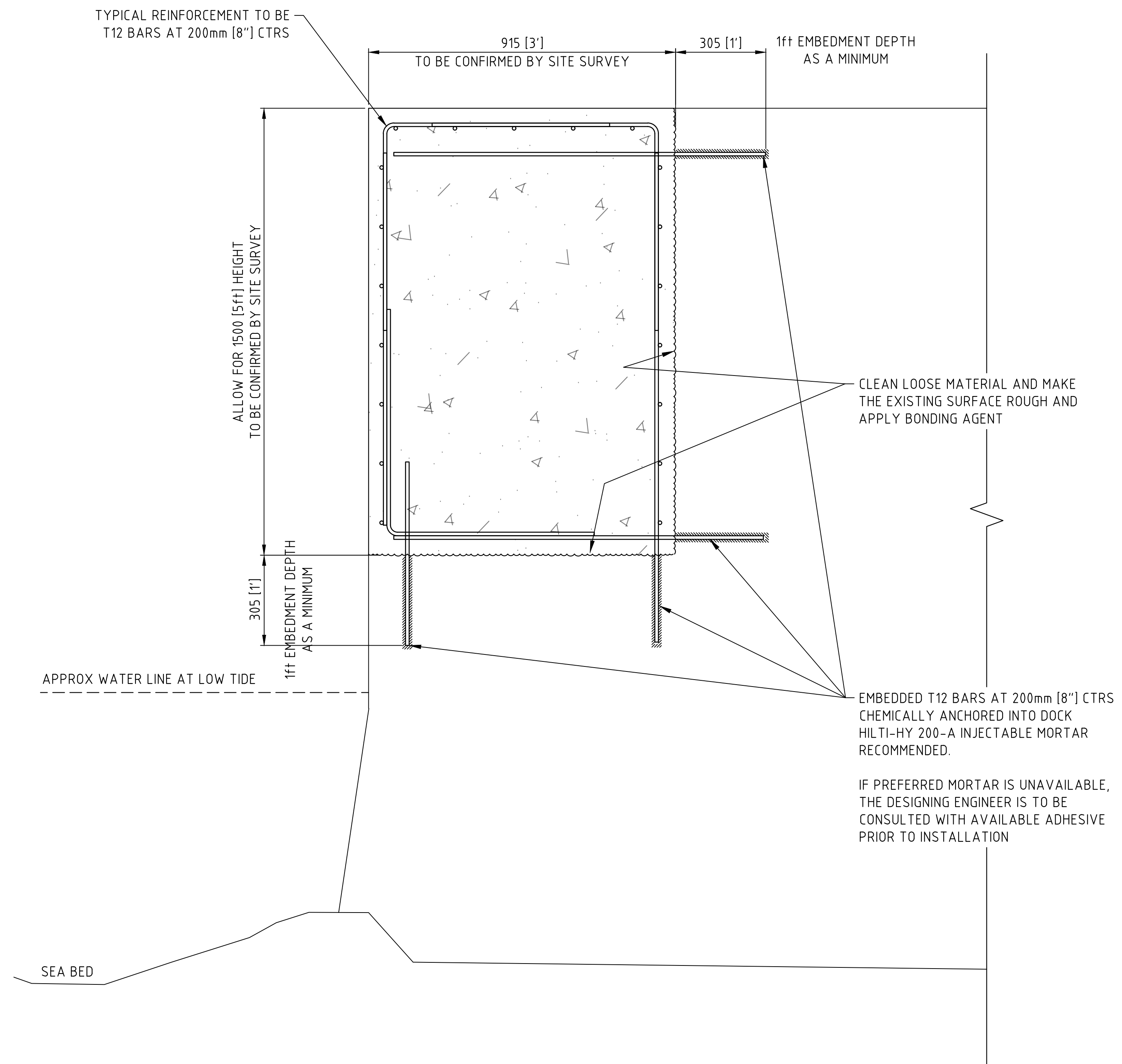

SECTION B-B  
1:10

ISSUED FOR: INFORMATION

| AMENDMENTS: |                 |          |
|-------------|-----------------|----------|
| NO.         | REVISION        | DATE:    |
| A           | FOR INFORMATION | 16/09/24 |
|             |                 |          |
|             |                 |          |
|             |                 |          |
|             |                 |          |

SCALE: AS SHOWN AT ANSI D

SURVEY  
PREPARED: - DATE: XX/XX/XXXX

DESIGN  
PREPARED: DATE: 16/09/2024  
CHECKED: A.KENNY DATE: 16/09/2024

DRAWING  
PREPARED: C.FRASER DATE: 16/09/2024  
CHECKED: A.KENNY DATE: 16/09/2024

APPROVED BY:  
A.KENNY - PRINC STRUCTURAL ENGINEER  
PROJECT NUMBER:  
-

PROJECT NAME:  
**PORTS ISLAND  
DOCK  
REPAIRS 2024**

SHEET TITLE:  
**NEW CONCRETE POUR  
SECTIONS**

SHEET NUMBER:  
**S005**

REVISION  
**A**