

1
RFQ-1

Existing/Demolition Ground Floor Plan
3/16" = 1'-0"

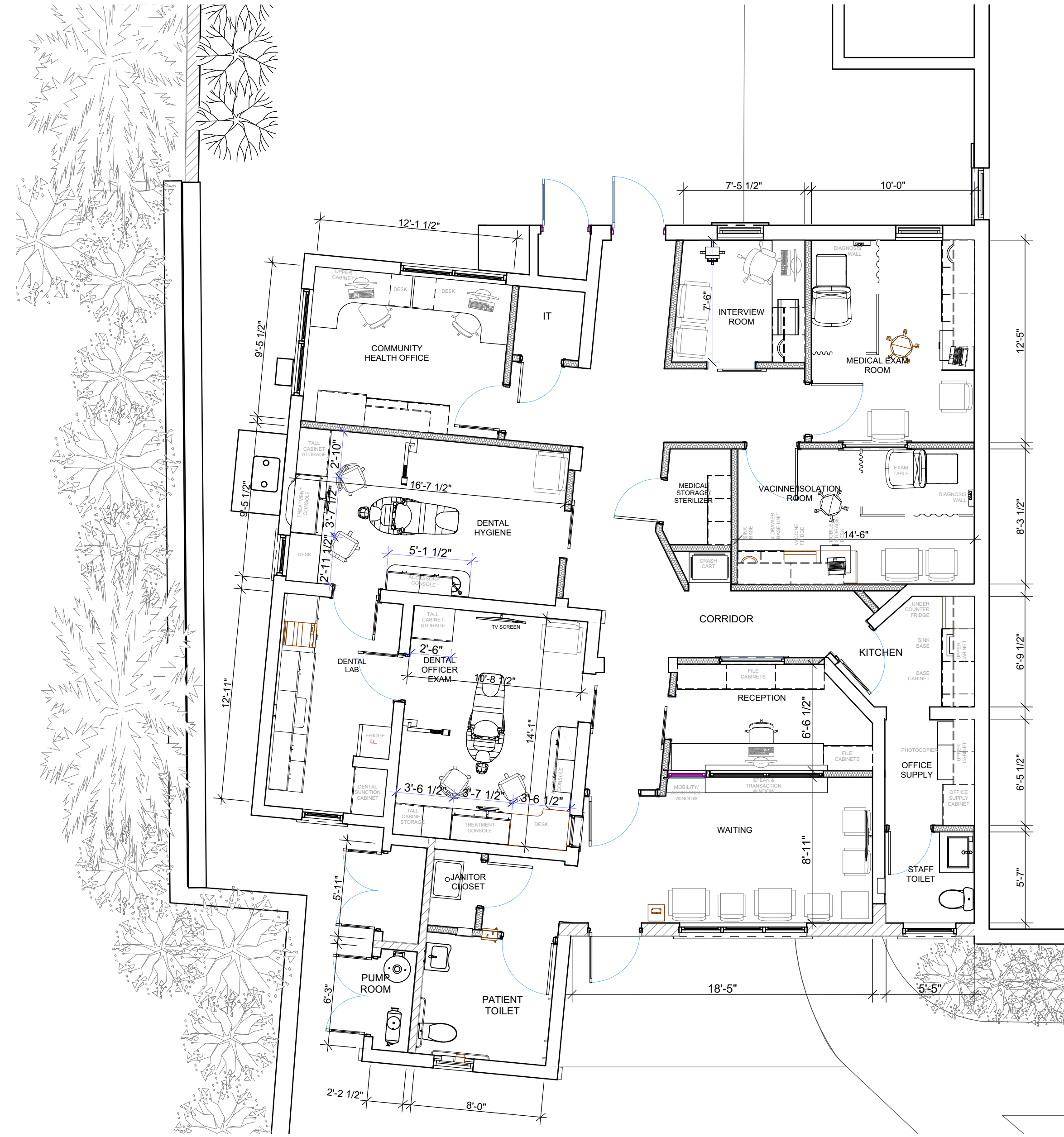

2
RFQ-1

Proposed Floor Plan
3/16" = 1'-0"

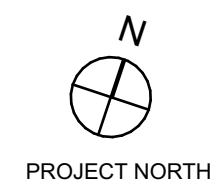

WALL LEGEND	
	EXISTING WALLS TO REMAIN
	EXISTING WALL TO BE DEMOLISHED
	PROPOSED CONCRETE BLOCK WALL
	PROPOSED CONCRETE FILLED WALL
	PROPOSED PARTITION WALL